

Arbor Lakes North

2,089 SF retail for lease

7900-7950 Main Street North
12680-12690 Arbor Lakes Parkway
Maple Grove, MN 55369

Dave Bergstrom
651-999-5532
dbergstrom@wellingtonmgt.com



WELLINGTON
MANAGEMENT



Work, shop, dine and walk at the Shoppes.

Arbor Lakes North is an office and retail building prominently located on Main Street in the dynamic Arbor Lakes commercial area of Maple Grove. The beautifully landscaped property offers an exclusive two-story lobby for the office users, full-service restaurants with patios, card-key access security system, ample surface parking and underground heated parking.

Arbor Lakes North is home to a diverse mix of national, regional and local tenants that promote strong retail traffic. Tenants and visitors enjoy the serene view of North Arbor Lake, seasonal community events, and adjacency to Maple Grove's premier trail system connecting several beautiful lakes, Town Green Park and the Maple Grove Bandshell nearby.

HIGHLIGHTS

- Part of The Shoppes at Arbor Lakes, a high-traffic commercial area
- Ample surface parking and 56 underground tempered parking stalls
- Ideally located north of Interstates 494, 94 and 694
- Adjacent to Maple Grove's premier trail system, which connects several beautiful lakes and Town Green Park
- Tenants include 3 Squares Restaurant, Riviera Maya Cantina, Brookwest Dental, Belladerm Med Spa, among others

Space Available

Owner, Manager, Leasing

81,000 SF total

32,900 total retail; 2,089 SF available

26,834 total office; 0 SF available

Surface & underground, 4.3 : 1,000

Two-story retail & office building

Built in 2004

Northwest Metro

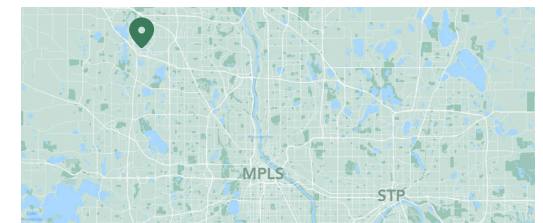

Available Suites



Suite 105B - 2,089 SF

3D Tour 

Floor Plan - First Floor

- Building Common Areas
- Available Space
- Occupied Space

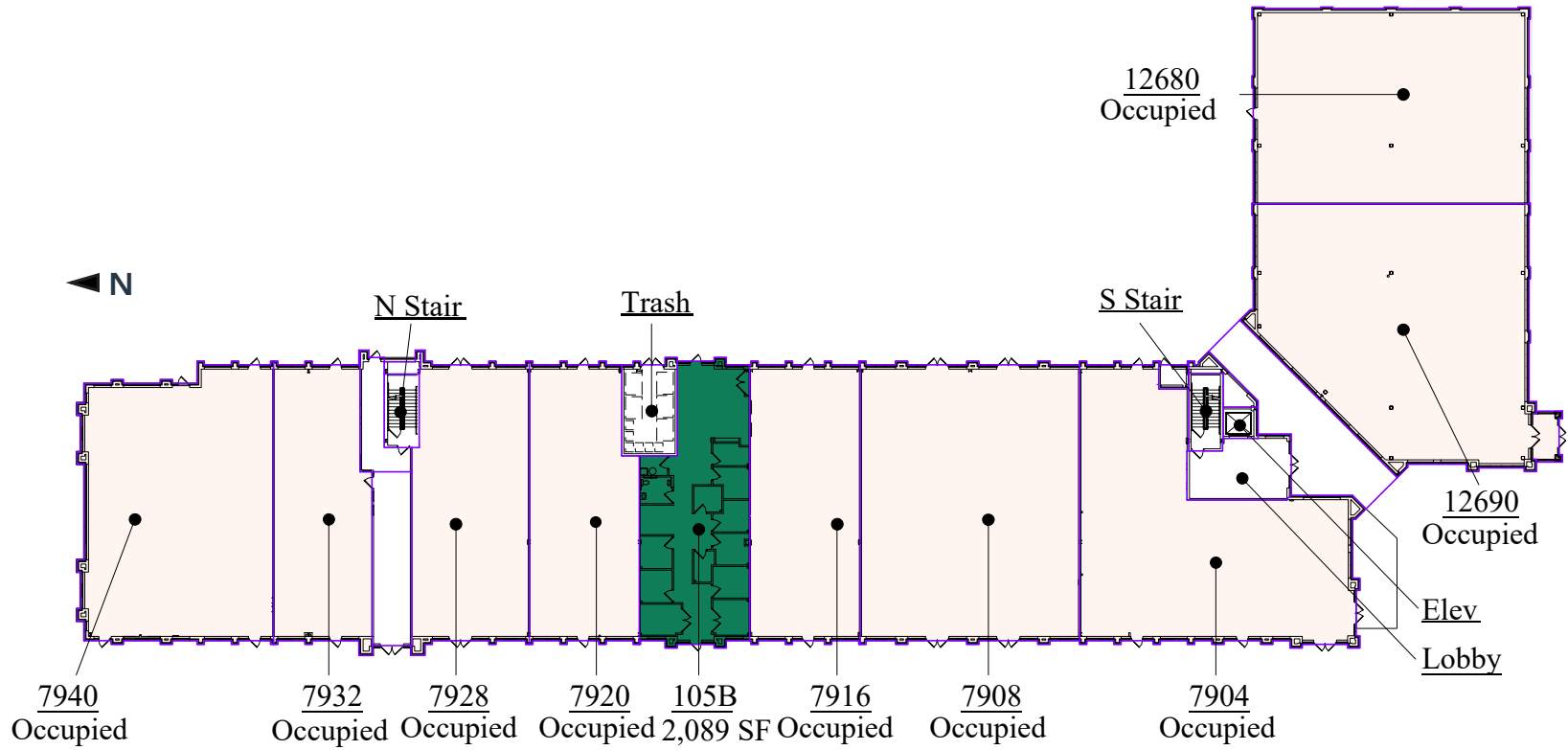

Floor Plan - Second Floor

- Building Common Areas
- Available Space
- Occupied Space

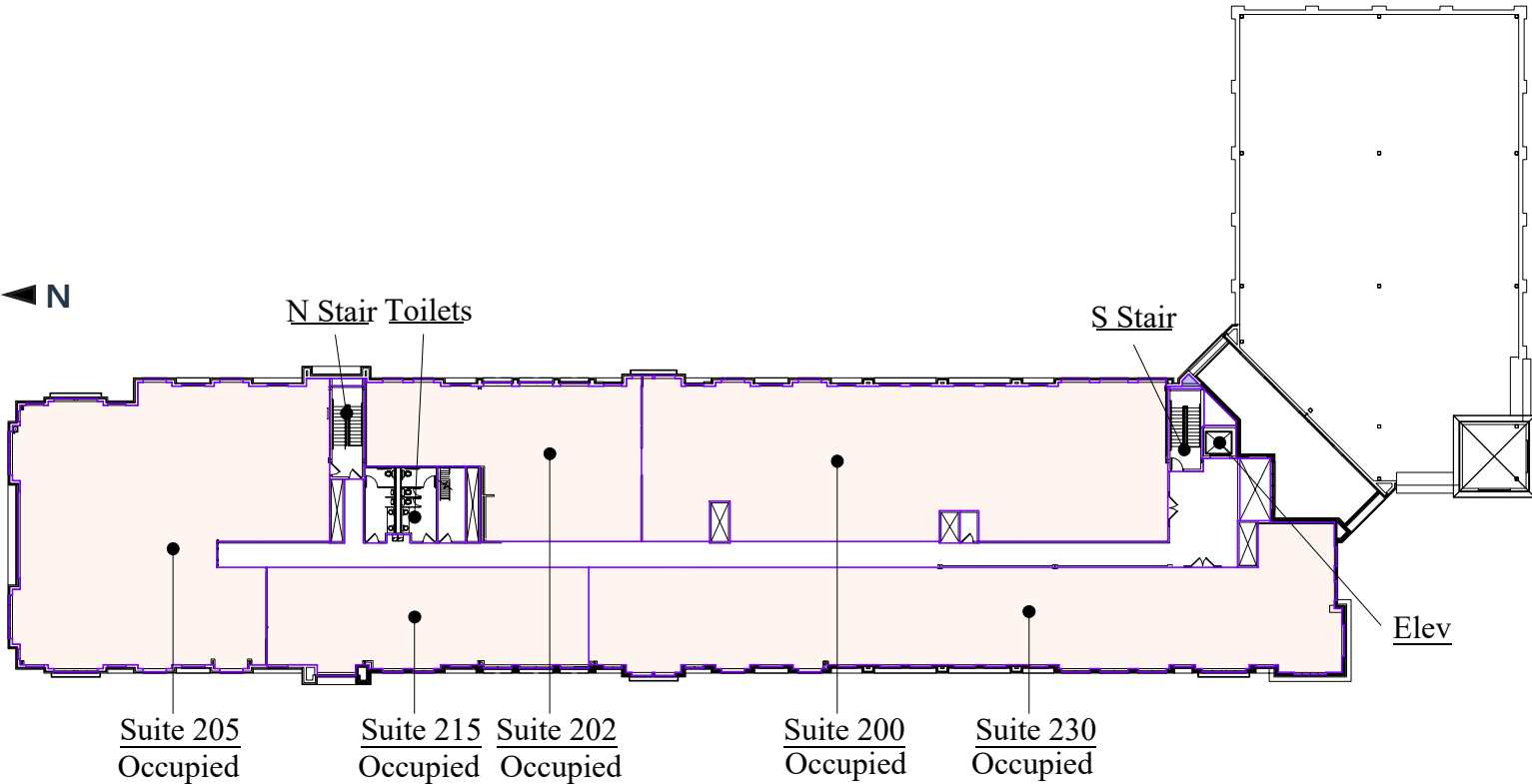

Site Plan

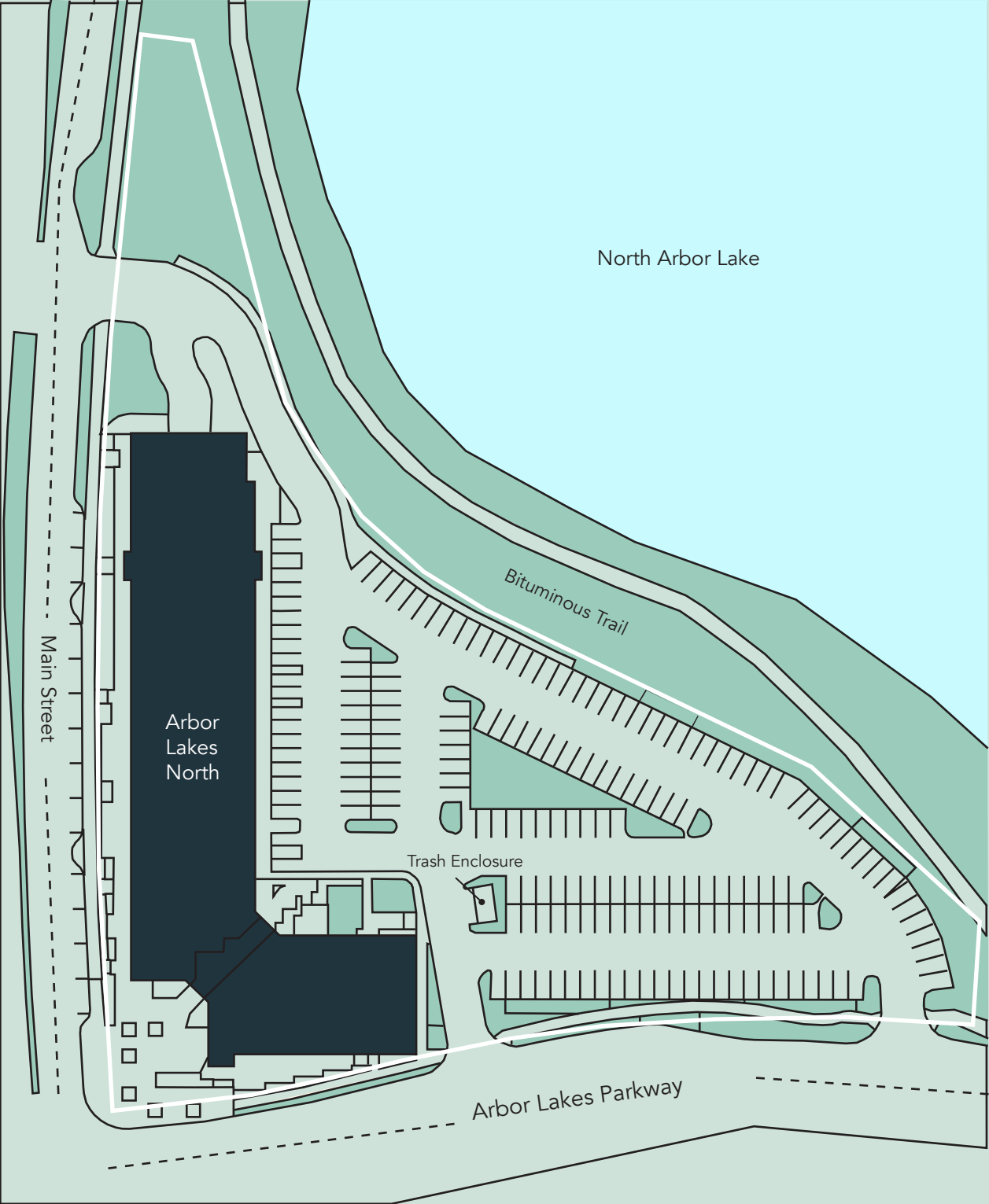

North Arbor Lake

Bituminous Trail

Arbor
Lakes
North

Main Street

Trash Enclosure

Arbor Lakes Parkway

The Neighborhood

Demographics	1 MILE	3 MILES	5 MILES
POPULATION	7,898	54,949	171,148
HOUSEHOLDS	3,546	21,106	63,700
AVG. INCOME	\$96,313	\$120,399	\$108,812

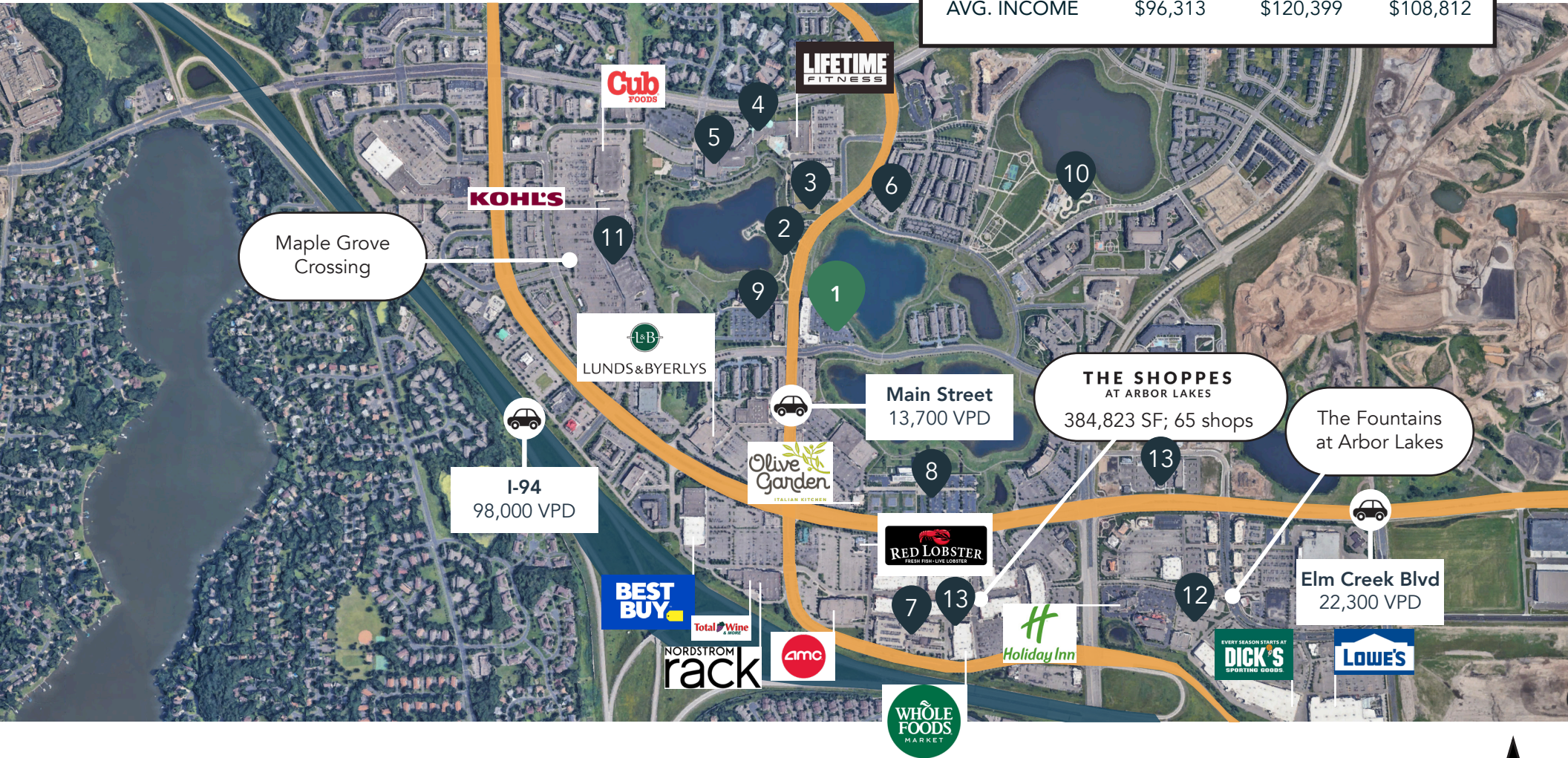

Hot Spots

- | | | | |
|------------------------|--------------------------------|----------------------------------|----------------------------------|
| 1. Arbor Lakes North | 5. Ice Arena | 9. Maple Grove Government Center | 12. The Fountains at Arbor Lakes |
| 2. Town Green Park | 6. Arbor Lakes Commons | 10. Central Park | 13. The Shoppes at Arbor Lakes |
| 3. Maple Grove Library | 7. Maple Grove Transit Station | | |
| 4. Community Center | 8. Great River Energy | 11. Maple Grove Crossing | |

Arbor Lakes North

7900-7950 Main Street North
12680-12690 Arbor Lakes Parkway
Maple Grove, MN 55369



PROPERTY MANAGER
LEASING AGENT

Dave Bergstrom

651-999-5532
dbergstrom@wellingtonmgt.com



St. Paul-based Wellington Management, Inc. owns, manages and develops commercial and residential properties throughout the Twin Cities metro area. We work to make long-term community impact through careful district planning and neighborhood relationships.

Main (651) 292-9844
Fax (651) 292-0072
wellingtonmgt.com

Wellington Management © 2021 All rights reserved.