

# City Centre Shoppes

8470 City Centre Drive  
Woodbury, MN 55125

Claudia Walker  
651-999-5561  
[cwalker@wellingtonmgt.com](mailto:cwalker@wellingtonmgt.com)



**WELLINGTON**  
MANAGEMENT



### Fully Occupied

Owner, Developer, Manager, Leasing

18,000 SF total

89 surface stalls, 4.9 : 1,000 SF

East Metro

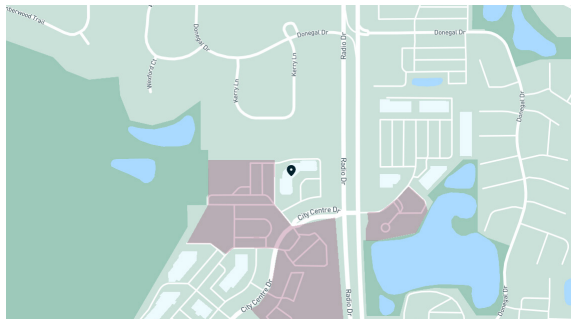

### Centrally located mix of retail for our neighbors to the east.

City Centre Shoppes is a community shopping center located in Woodbury's City Centre district. The attractive L-shaped center features an all-brick exterior with warm earth-toned roof canopies and gold metal awnings. The property hosts Hirshfield's, Subway, Woodbury Cleaners, Wayback Burgers, among others.

### HIGHLIGHTS

- Located in Woodbury's City Centre district
- Notable tenants are Hirshfield's, Subway, Woodbury Cleaners and Wayback Burgers
- Affluent population within one mile (average household income ~\$134,587)
- Near a density of major residential communities, including Evergreen, the Seasons Villas, Interlachen Woods and Wedgewood
- 16' clear height

# Floor Plans

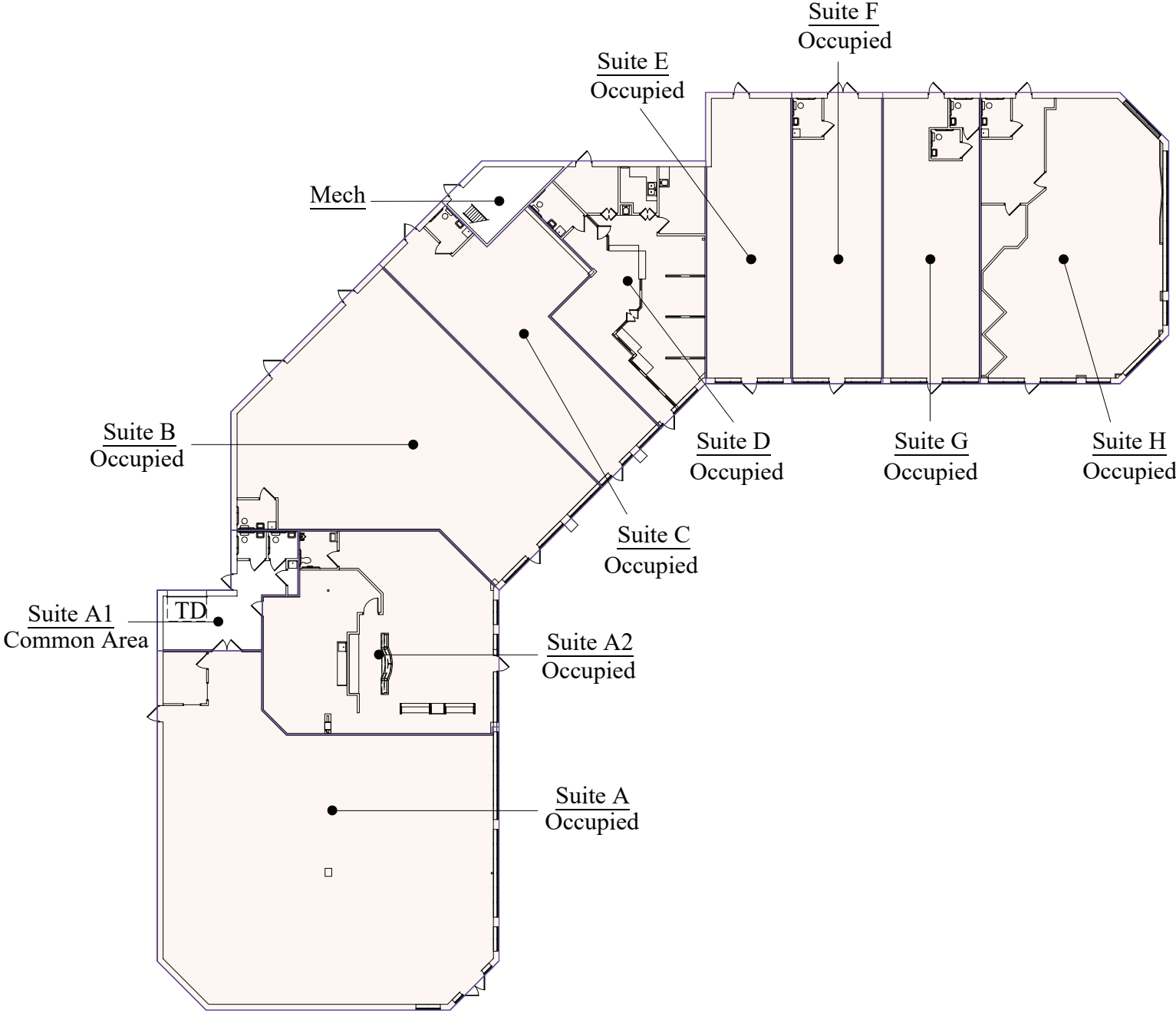

# City Centre Shoppes

8470 City Centre Drive  
Woodbury, MN 55125

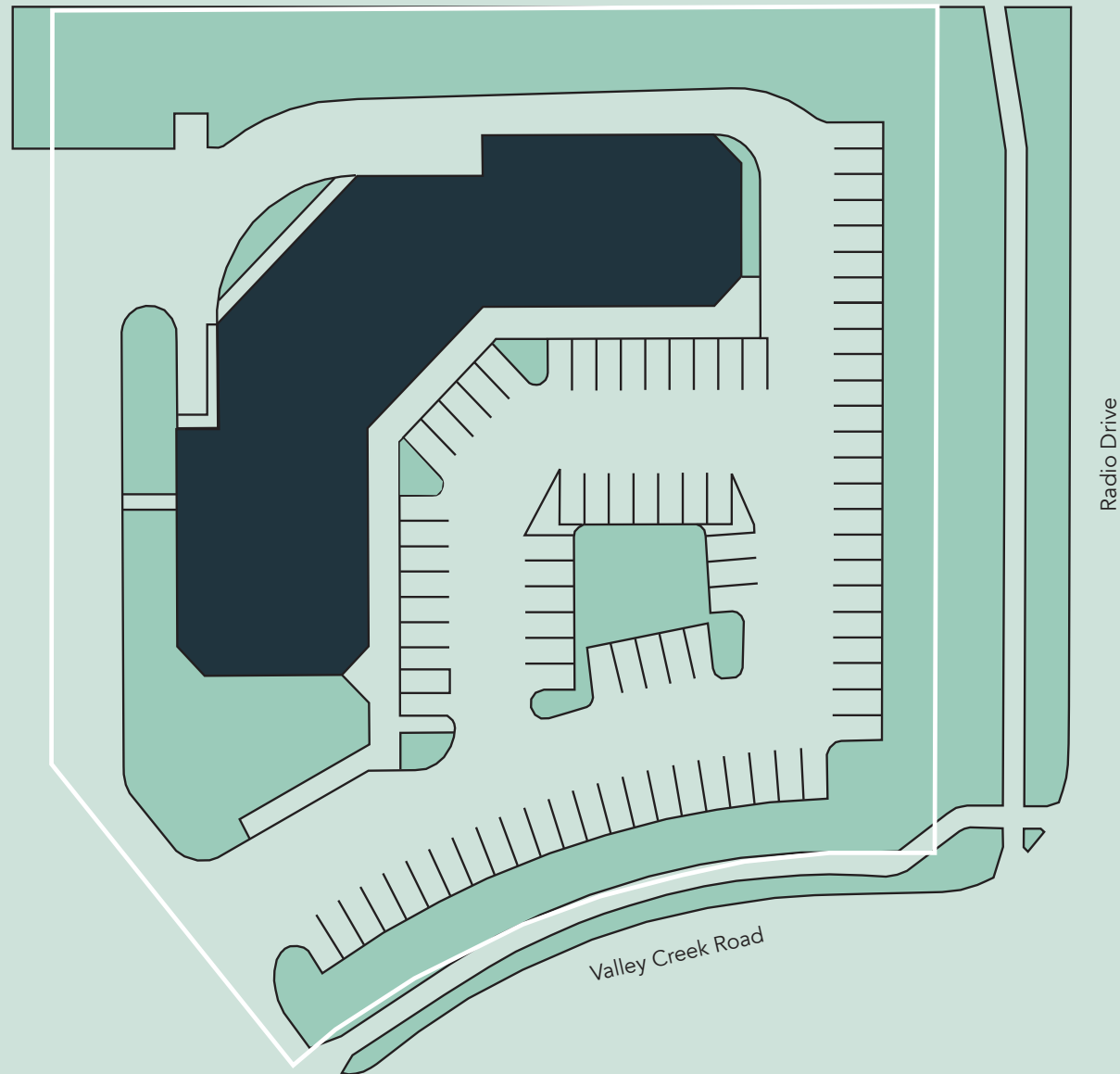

# The Neighborhood

Demographics	1 MILE	3 MILES	5 MILES
POPULATION	11,287	75,431	152,073
HOUSEHOLDS	4,194	29,088	56,537
AVG. INCOME	\$155,556	\$153,252	\$139,981

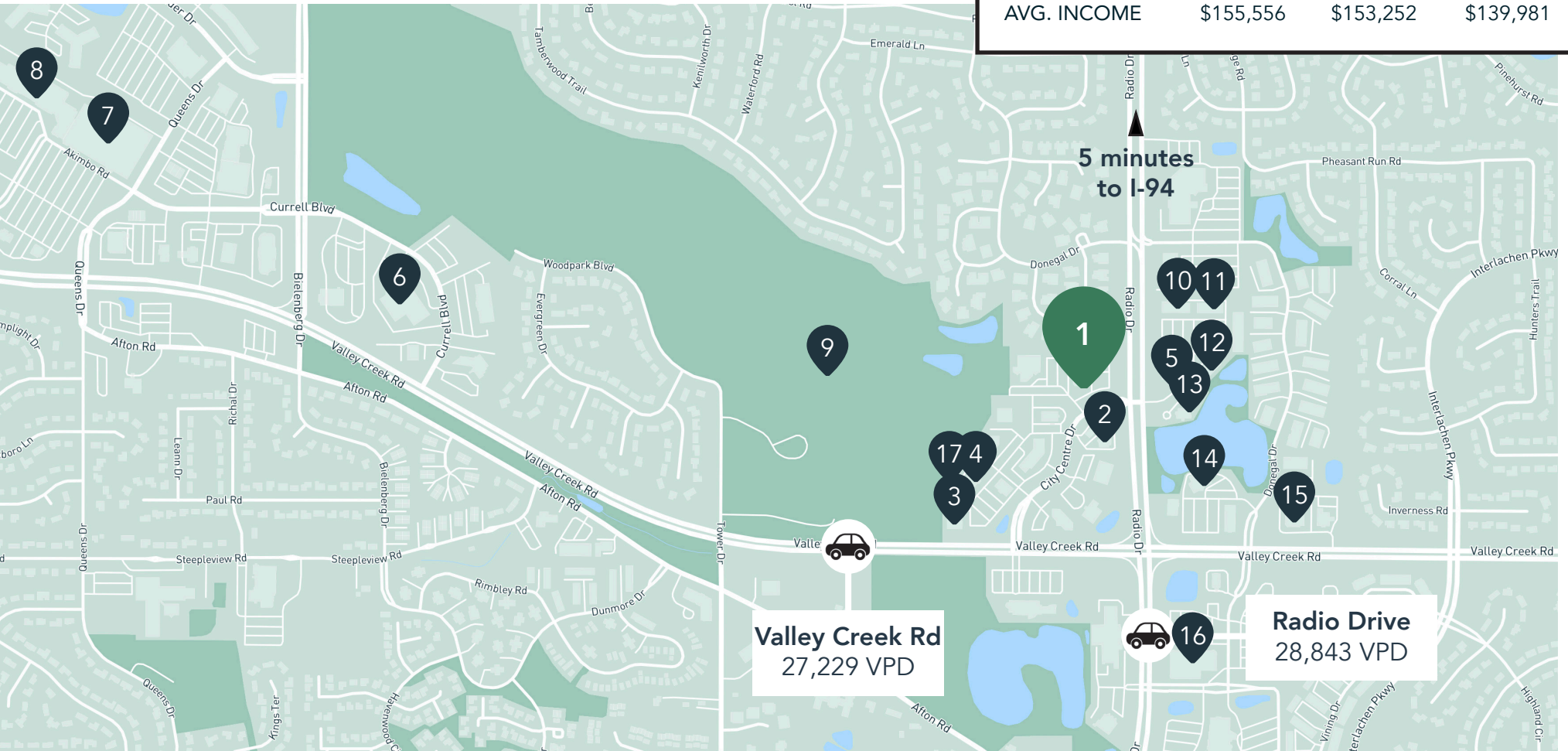

## Hot Spots

- |                        |                             |                       |                       |
|------------------------|-----------------------------|-----------------------|-----------------------|
| 1. City Centre Shoppes | 6. U.S. Postal Service      | 11. Acapulco          | 16. Kowalski's Market |
| 2. Kwik Trip           | 7. Target                   | 12. Erik's            | 17. Bruegger's Bagels |
| 3. Punch Pizza         | 8. Total Wine               | 13. Associated Bank   |                       |
| 4. Patina              | 9. Tamarack Nature Preserve | 14. Old National Bank |                       |
| 5. Panera Bread        | 10. Leeann Chin             | 15. Walgreens         |                       |

# City Centre Shoppes

8470 City Centre Drive  
Woodbury, MN 55125



PROPERTY MANAGER  
LEASING AGENT

Claudia Walker

651-999-5561  
[cwalker@wellingtonmgt.com](mailto:cwalker@wellingtonmgt.com)



St. Paul-based Wellington Management, Inc. owns, manages and develops commercial and residential properties throughout the Twin Cities metro area. We work to make long-term community impact through careful district planning and neighborhood relationships.

Main (651) 292-9844  
Fax (651) 292-0072  
[wellingtonmgt.com](http://wellingtonmgt.com)

Wellington Management © 2021 All rights reserved.