

Eagandale Corporate

19,238 SF of industrial/flex space available!

1020 Discovery Road
Eagan, MN 55121



Ashley Urlick (Burdine), Property Manager
651-999-5506
aurlick@wellingtonmgt.com



Flexible office space minutes from Eagan Town Centre.

Eagandale Corporate is a single-story office building located at the high-traffic intersection of Yankee Doodle Road and Lexington Avenue just east of Interstate 35E and west of Hwy 55. Four minutes to the east, tenants enjoy convenient access to big-box retailers and well over a dozen restaurants at Eagan Town Centre.

As a whole, Eagan benefits from significant infrastructure, including its proximity to the Minneapolis/St. Paul International Airport. It also offers executive housing options with reasonable commute times to the cities of Farmington, Cottage Grove and Lakeville, as well as the Twin Cities metro area.

HIGHLIGHTS

- Located at the intersection of Yankee Doodle Road (24,000 VPD) and Lexington Avenue (17,700 VPD) just east of Interstate 35E
- Building signage opportunity
- Close proximity to Eagan Town Centre (4 minutes) and MSP International Airport (12 minutes)
- Ample surface parking
- 16' clear height

Space Available

Owner, Manager, Leasing

80,000 SF total; 19,238 SF available

357 surface stalls, 4.5 : 1,000 SF

Single-story office building

Built in 1998

Southeast Metro

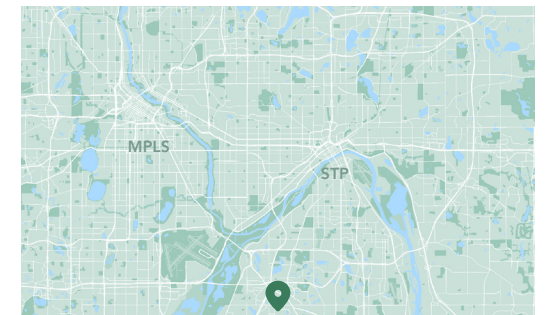

Available Suites



Suite 160 & 180 - 19,238 SF **3D Tour** 

Floor Plan

- Building Common Areas
- Available Space
- Occupied Space

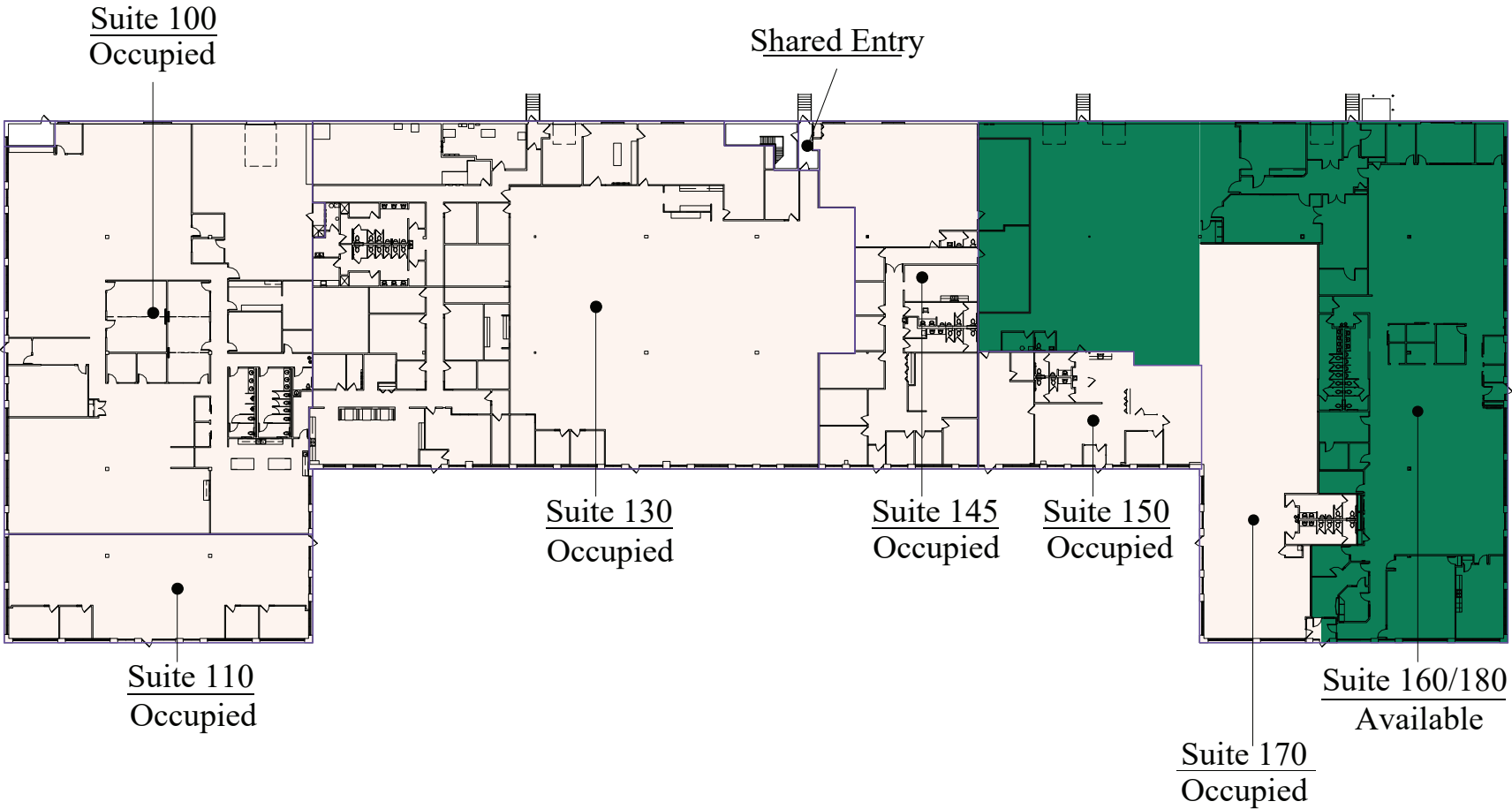

Site Plan

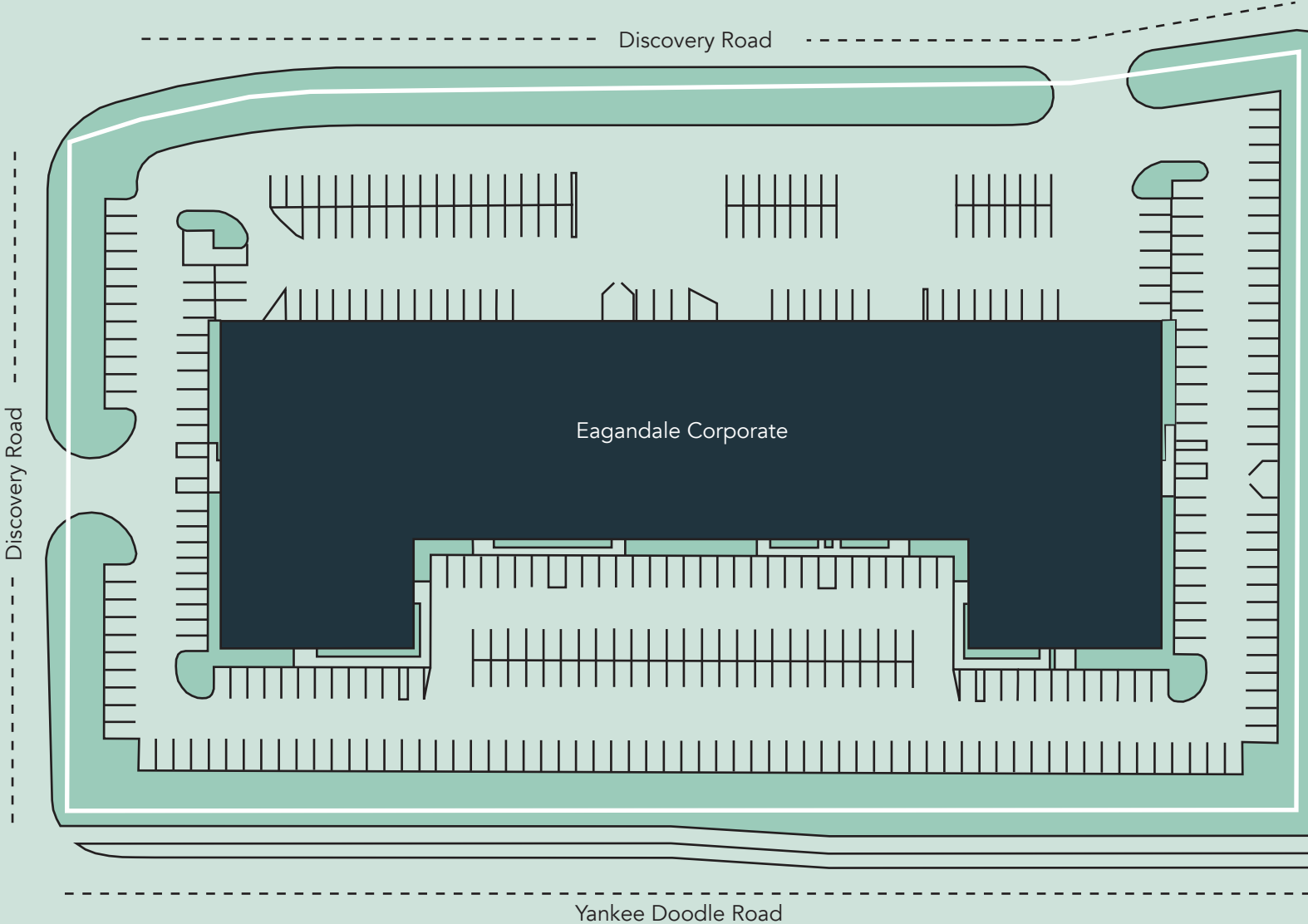

The Neighborhood

Demographics	1 MILE	3 MILES	5 MILES
POPULATION	9,468	50,135	112,910
HOUSEHOLDS	4,261	19,740	46,944
AVG. INCOME	\$142,343	\$161,549	\$151,668

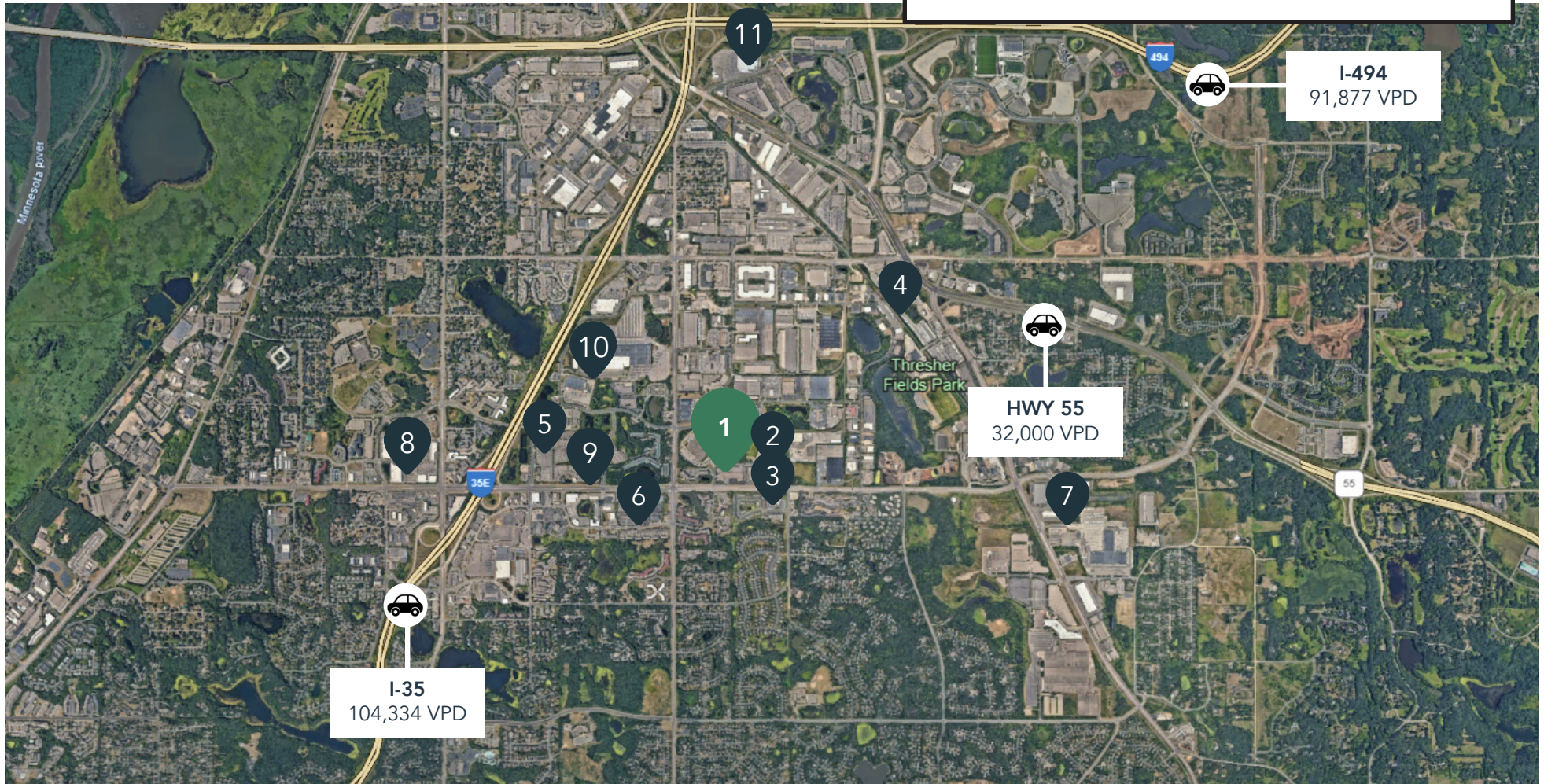

Hot Spots



- | | | |
|---------------------------|---------------------------|-----------------------|
| 1. Eagandale Corporate | 5. Lunds & Byerlys | 9. Buffalo Wild Wings |
| 2. Chip's Pickleball Club | 6. Culver's & Chick-fil-A | 10. Home Depot |
| 3. Eagan Fire Department | 7. Eagan YMCA | 11. Costco Wholesale |
| 4. Kwik Trip | 8. Hy-vee | |

Eagandale Corporate

1020 Discovery Road
Eagan, MN 55121



PROPERTY MANAGER
LEASING AGENT

Ashley Urlick (Burdine)

651-999-5506
aurlick@wellingtonmgt.com



St. Paul-based Wellington Management, Inc. owns, manages and develops commercial and residential properties throughout the Twin Cities metro area. We work to make long-term community impact through careful district planning and neighborhood relationships.

Main (651) 292-9844
Fax (651) 292-0072
wellingtonmgt.com

Wellington Management © 2021 All rights reserved.