

# EASTERN HEIGHTS







7582 Currell Boulevard, Woodbury, MN 55125

# SITE PLAN

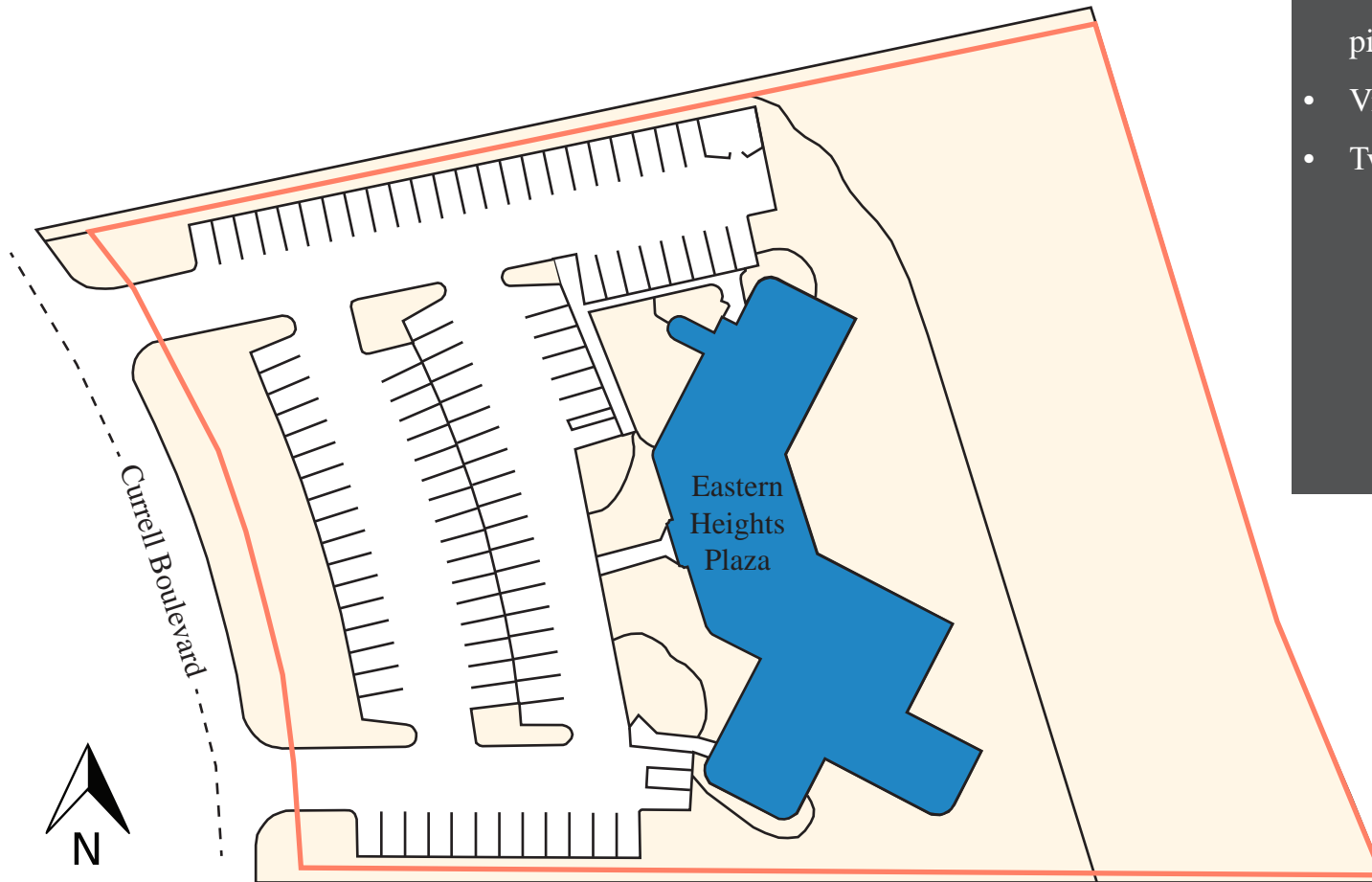
## PROPERTY HIGHLIGHTS

- Newly remodeled common areas
- ADA compliant
- Conveniently located near banks, shopping and restaurants
- View of Nature Preserve
- Two-story office building



-  Parking Lot/Sidewalk
-  Building
-  Landscape
-  Property Line

ADDRESS

7582 Currell Boulevard, Woodbury, MN 55125

BUILDING AREA

24,100 SF

NUMBER OF STORIES

2

PARKING STALLS

109 Stalls

YEAR BUILT

1984





# FLOOR PLANS

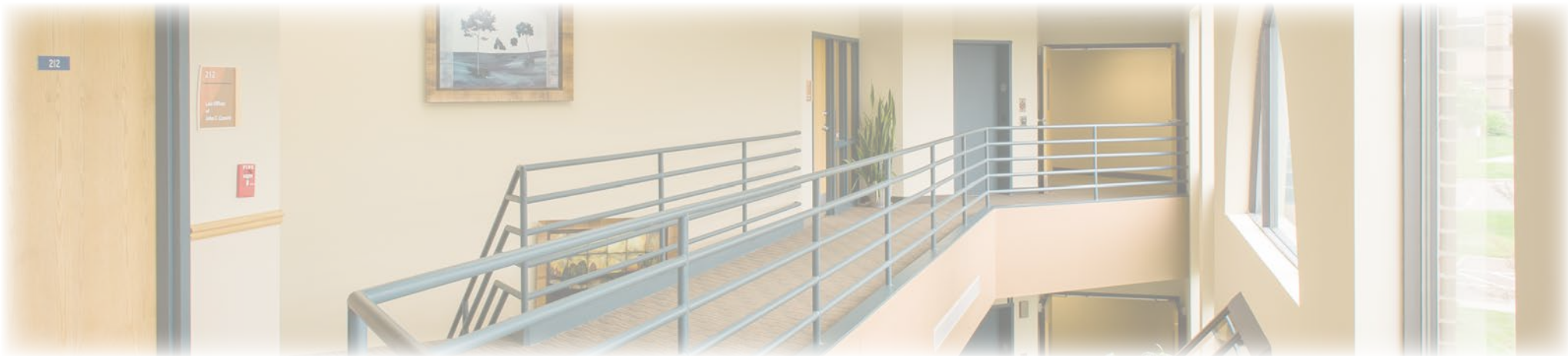
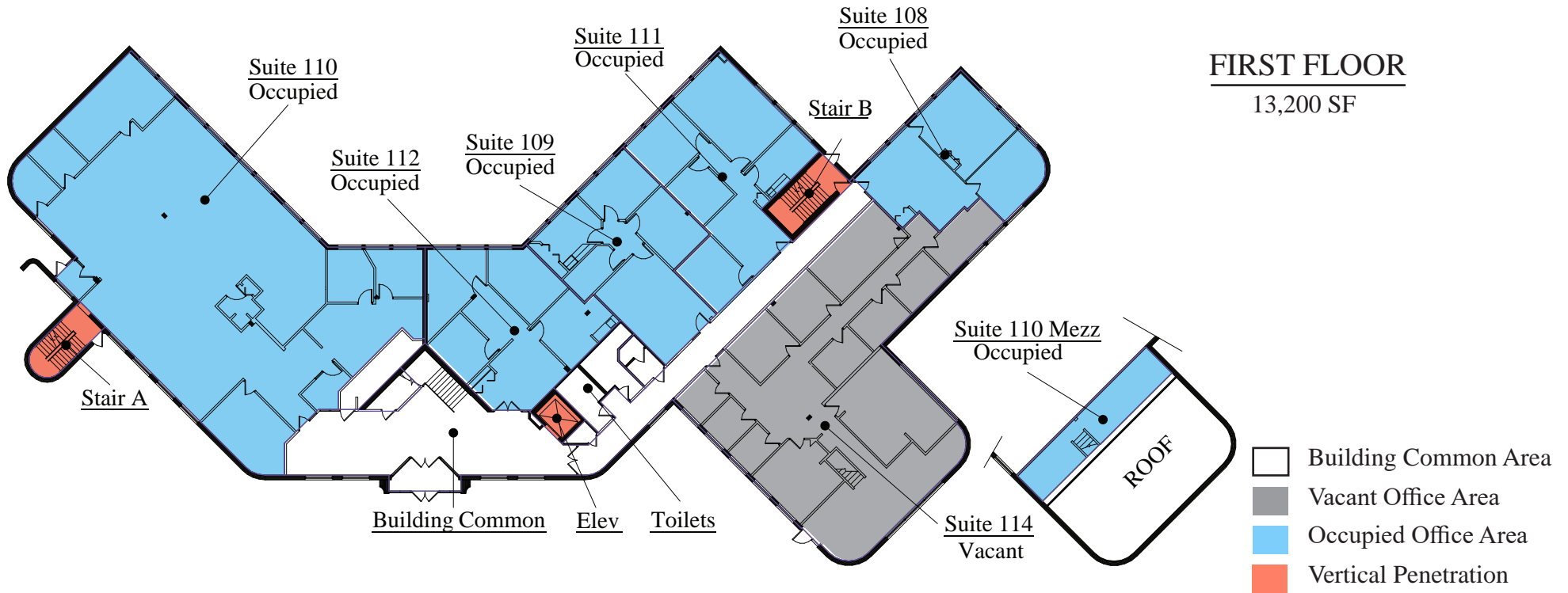

# FLOOR PLANS

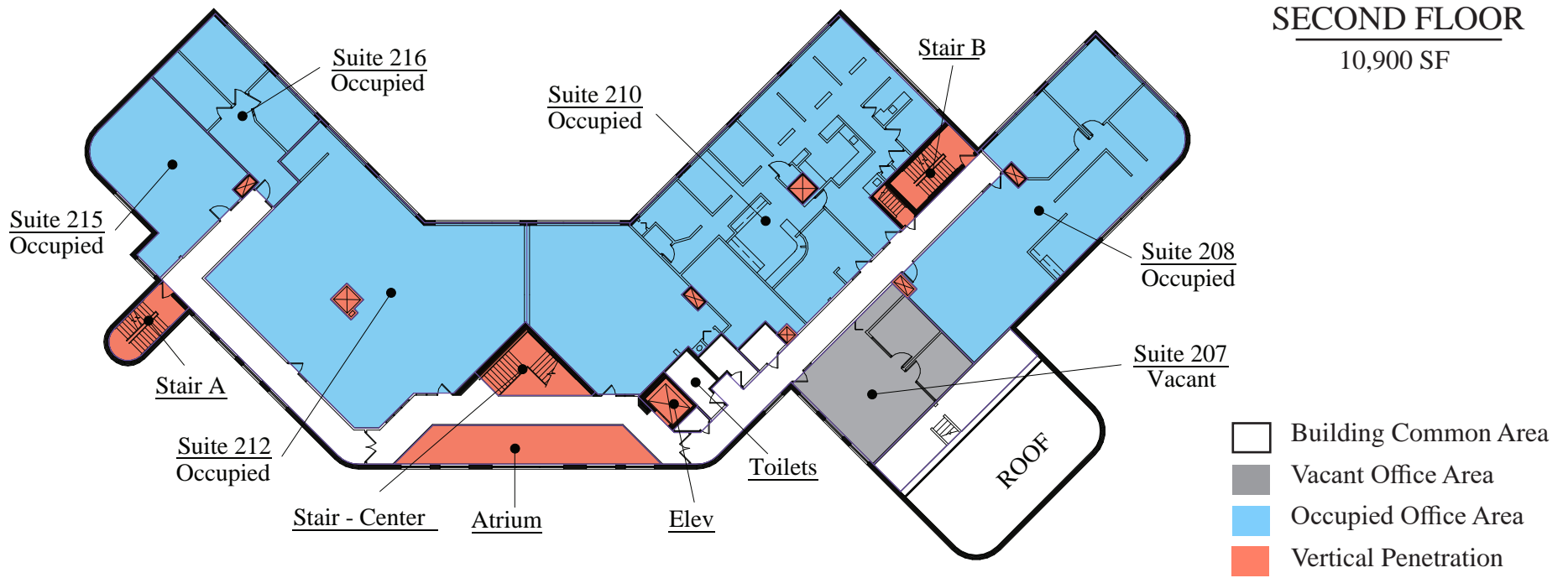



# AREA DEMOGRAPHICS

	1 MILE	3 MILES	5 MILES
POPULATION	7,825	69,442	146,101
HOUSEHOLDS	3,030	26,187	54,273
HOUSEHOLD INCOME	\$113,301	\$115,298	\$103,228

BIELBERG DRIVE 9,800 VPD

CURRELL BOULEVARD 5,100 VPD

VALLEY CREEK ROAD 23,300 VPD





# CONTACTS

## **Kathy Bayliss, CPM, CCIM**

Property Manager & Leasing Agent  
(651) 999-5509 Direct  
kbayliss@wellingtonmgt.com

## **Judy Olson**

Customer Service & Property Administrator  
(651) 999-5541 Direct  
(651) 999-5516 Customer Service  
jolson@wellingtonmgt.com

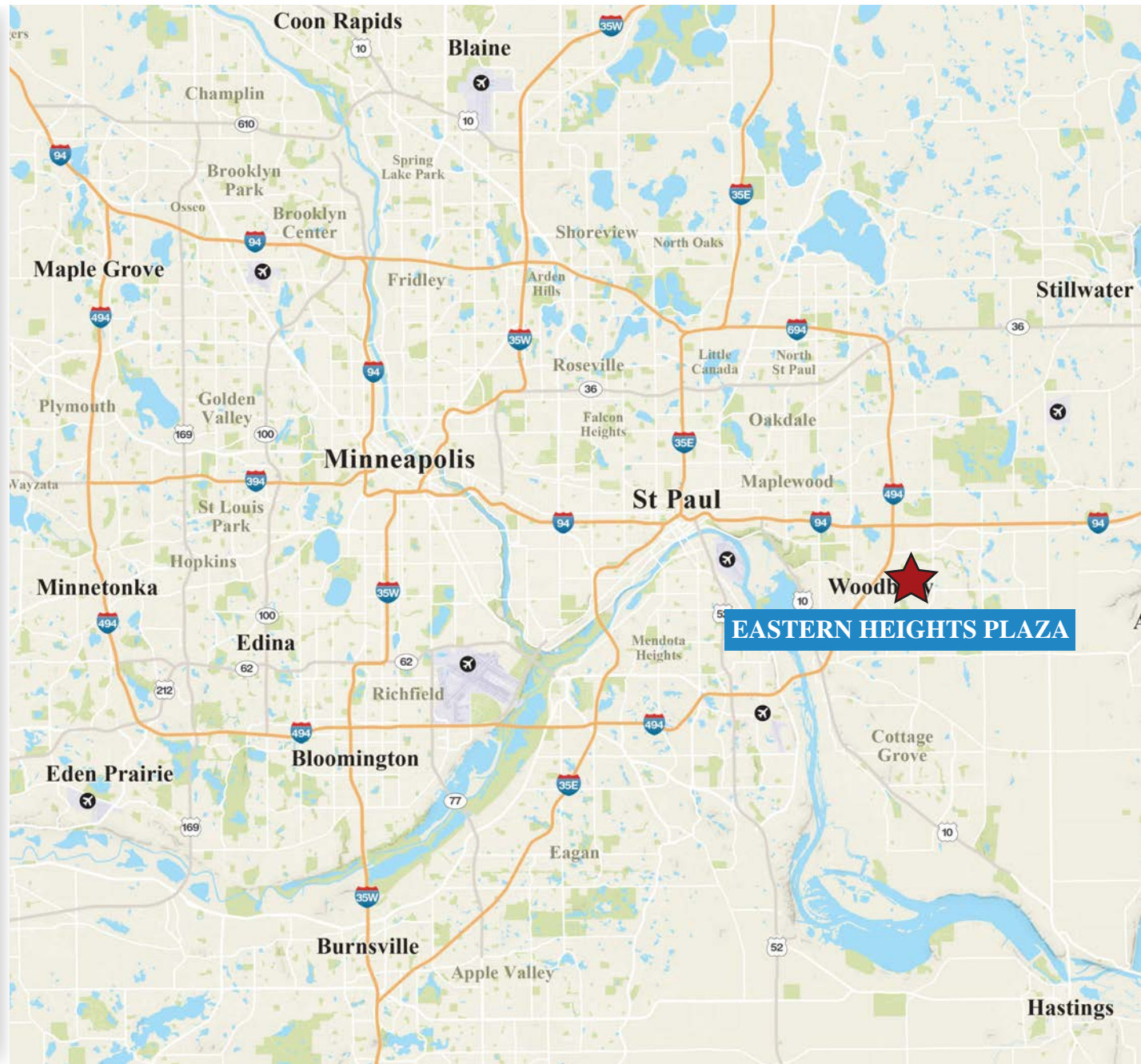

1625 Energy Park Drive, Suite 100, St. Paul, MN 55108 | Main (651) 292-9844 | Fax (651) 292-0072 | wellingtonmgt.com