

Falcon Crossing

1533-1559 West Larpenteur Avenue
Falcon Heights, MN 55113

Justin Bryant
651-999-5548
jbryant@wellingtonmgt.com



WELLINGTON
MANAGEMENT

Space Available

Owner, Manager, Leasing

27,000 SF total; 1,526 SF available

98 surface stalls, 4.5 : 1,000 SF

Single-story retail building

12'6" clear height

Built in 1985

St. Paul

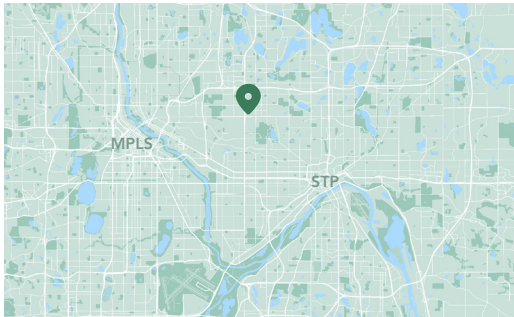

A LOCAL RETAIL MAGNET SURROUNDED BY RESIDENTIAL DEVELOPMENT.

Constructed in 1985, Falcon Crossing is a neighborhood retail center located at the corner of Larpenteur and Snelling Avenues in the heart of Falcon Heights. The highly visible brick building is located just south of Rosedale and HarMar malls and near the University of Minnesota's St. Paul campus and the Minnesota State Fairgrounds.

Wellington acquired Falcon Crossing in 1994 and has worked to upgrade the building's exterior and landscaping. This high-demand location has remained popular with local tenants, with the project consistently remaining close to fully occupied. The diverse tenant mix includes national retailers like Jimmy John's and Toppers, as well as local businesses like Golden Tailor, Merwin Liquor and New Fresh Wok.

HIGHLIGHTS

- Located at the Snelling/Larpenteur intersection (56,000 VPD)
- Residential population within 3 miles: 100,000+
- Direct stop on major bus routes, including Rapid Bus Transit
- Minutes from Como Lake and all things Como Park (golf course, pool, parks, trails, zoo & conservatory)
- Close to the University of Minnesota and State Fairgrounds
- Just south of Rosedale Center and HarMar Mall

Available Suites



Suite 1549 - 1,526 SF

3D Tour [▶](#)

Floor Plan

- Building Common Areas
- Available Space
- Occupied Space

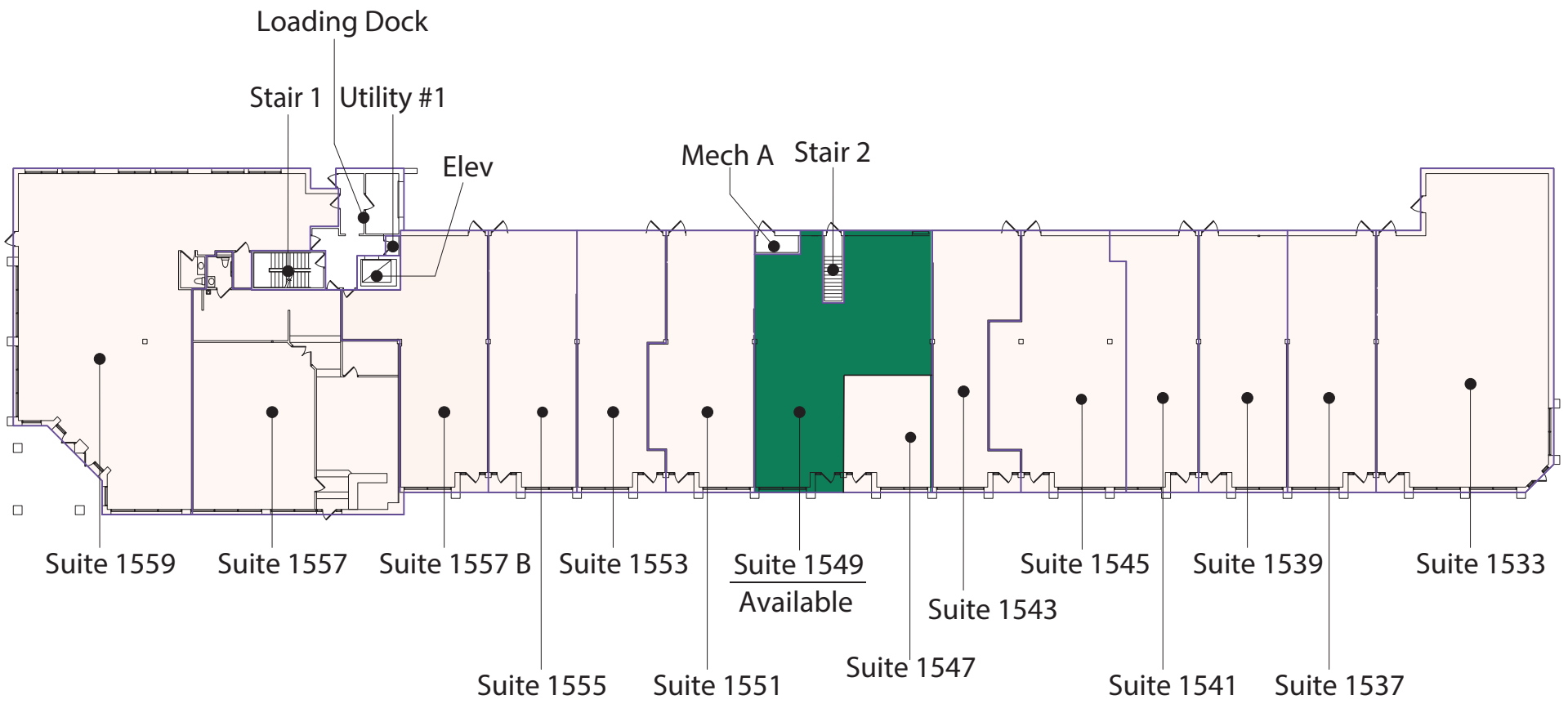

Floor Plan

- Building Common Areas
- Available Space
- Occupied Space

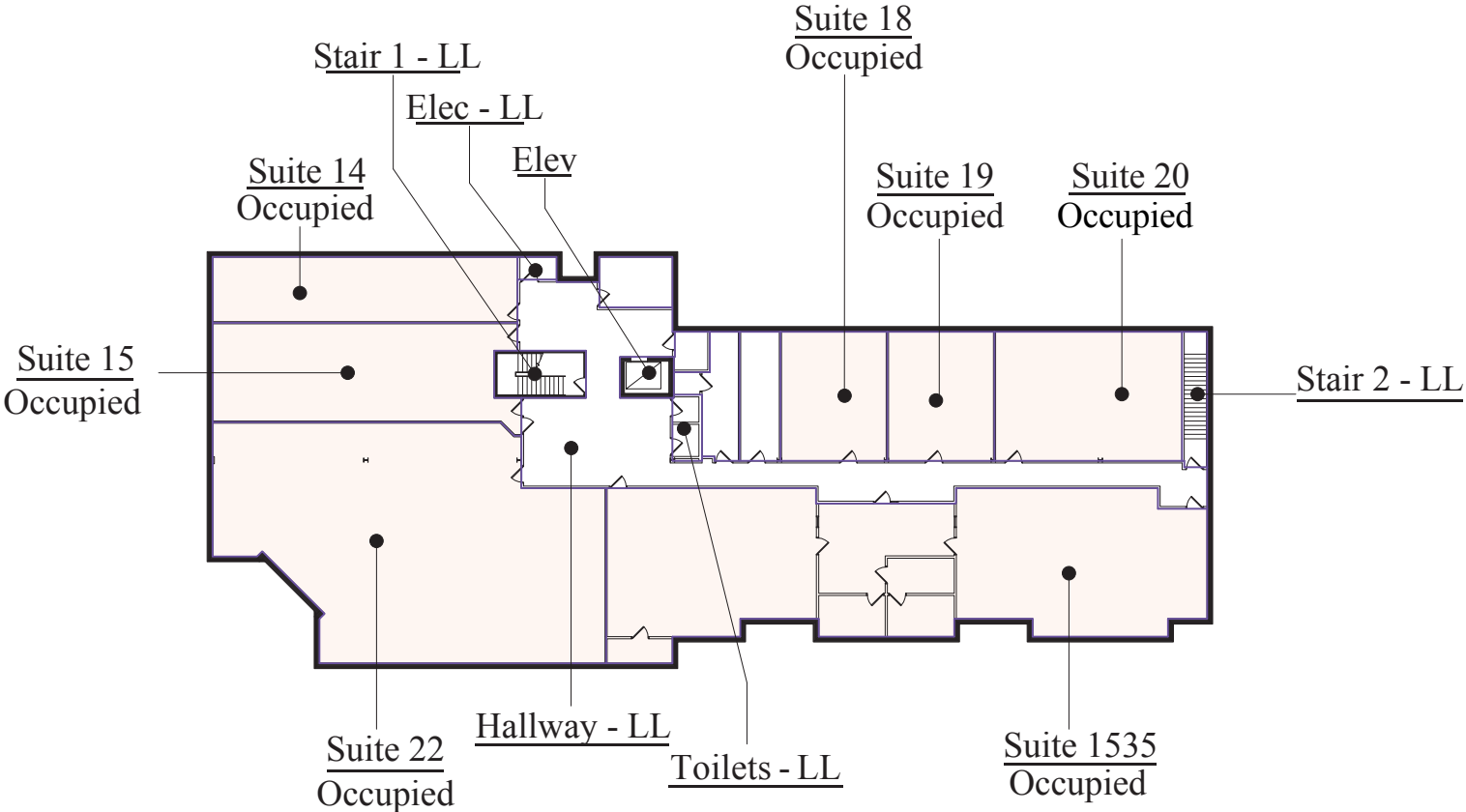

Site Plan

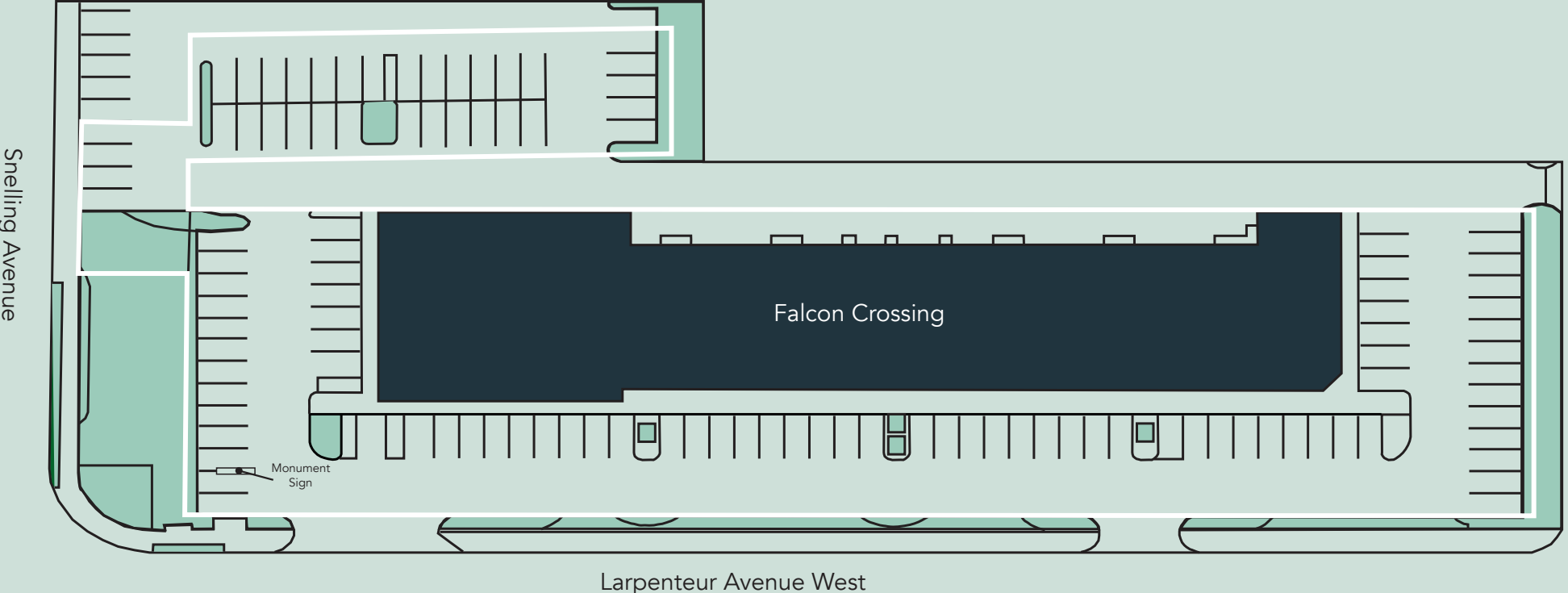

The Neighborhood

Demographics	1 MILE	3 MILES	5 MILES
POPULATION	12,346	111,801	413,184
HOUSEHOLDS	5,164	46,488	172,404
AVG. INCOME	\$115,568	\$98,012	\$102,429



Hot Spots

- | | | |
|-------------------------|----------------------|-------------------------------|
| 1. Falcon Crossing | 5. State Fairgrounds | 9. Bell Museum |
| 2. Downtown Minneapolis | 6. Como Zoo | 10. Saint Anthony Park |
| 3. Rosedale Center | 7. U of M St. Paul | 11. Midland Hills Golf Course |
| 4. HarMar Mall | 8. Roseville Center | 12. U of M Minneapolis |

Falcon Crossing

1533-1559 West Larpenteur Avenue
Falcon Heights, MN 55113



PROPERTY MANAGER
LEASING AGENT

Justin Bryant

651-999-5548
jbryant@wellingtonmgt.com



WELLINGTON
MANAGEMENT

St. Paul-based Wellington Management, Inc. owns, manages and develops commercial and residential properties throughout the Twin Cities metro area. We work to make long-term community impact through careful district planning and neighborhood relationships.

Main (651) 292-9844
Fax (651) 292-0072
wellingtonmgt.com

Wellington Management © 2021 All rights reserved.