

Rosewood Office Plaza

2,759 SF of flexible office space for lease

1711 West County Road B
Roseville, MN 55113

Patrick Kyle
651-999-5529
pkyle@wellingtonmgt.com



WELLINGTON
MANAGEMENT



Ideally located office with space planning flexibility.

Rosewood Office Plaza is a three-story property located on five acres between St. Paul and Minneapolis and within three minutes of HarMar Mall and Rosedale Center. The building offers convenience and accessibility with free surface parking, a common lunch room, large windows for ample natural light and a shared conference room. The property consists of two buildings with a first-floor connector and currently houses contiguous vacancies to accommodate users of all sizes.

HIGHLIGHTS

- Common conference room and lunch room
- Updated carpeting, ceiling and lighting in common areas
- Expansive windows for abundant natural light
- Monument signage opportunity
- Shopping and dining within three minutes at HarMar Mall and Rosedale Center
- Landscaped green space with shade trees, picnic tables and an irrigation pond
- Large surface parking lot
- Quiet neighborhood

Space Available

Manager, Leasing

58,000 SF total; 2,759 SF available

306 surface stalls, 5.3 : 1,000 SF

Three-story office building

Built in 1984

North Metro

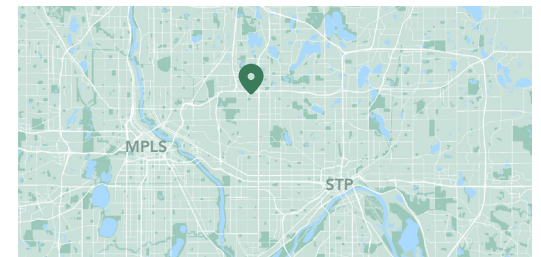

Available Suites



Suite 108S - 339 SF



Suite 111S - 2,420 SF [3D Tour](#)

Floor Plan - First Floor

- Building Common Areas
- Available Space
- Occupied Space

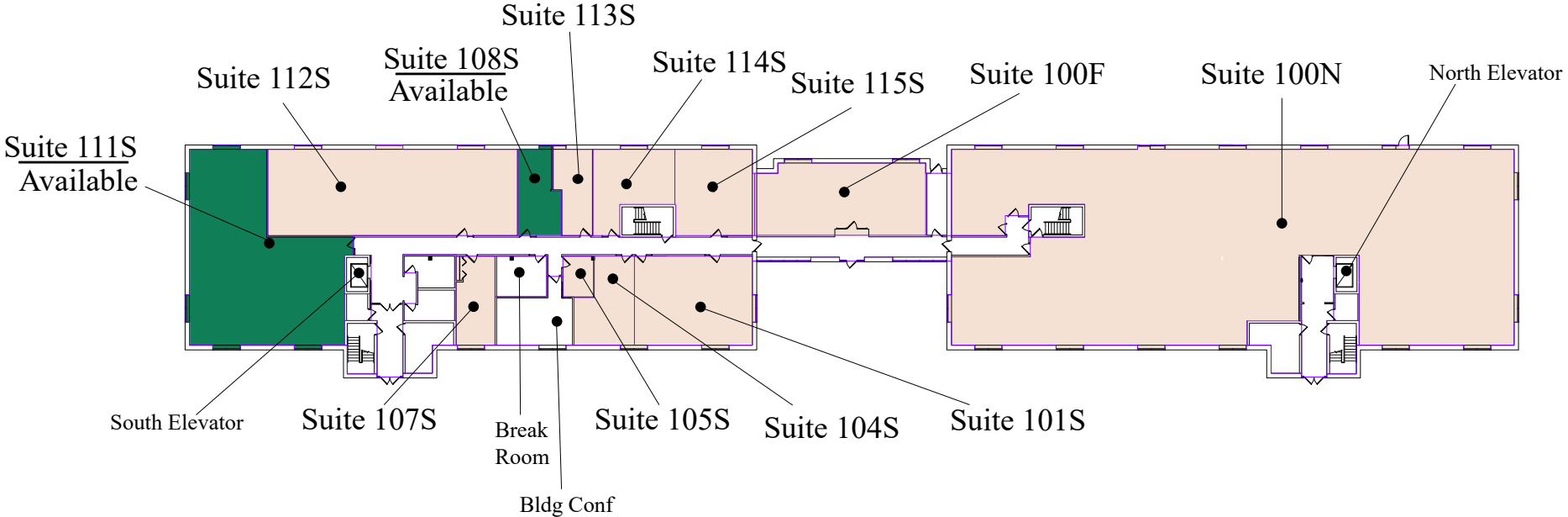

Floor Plan - Second Floor

- Building Common Areas
- Available Space
- Occupied Space

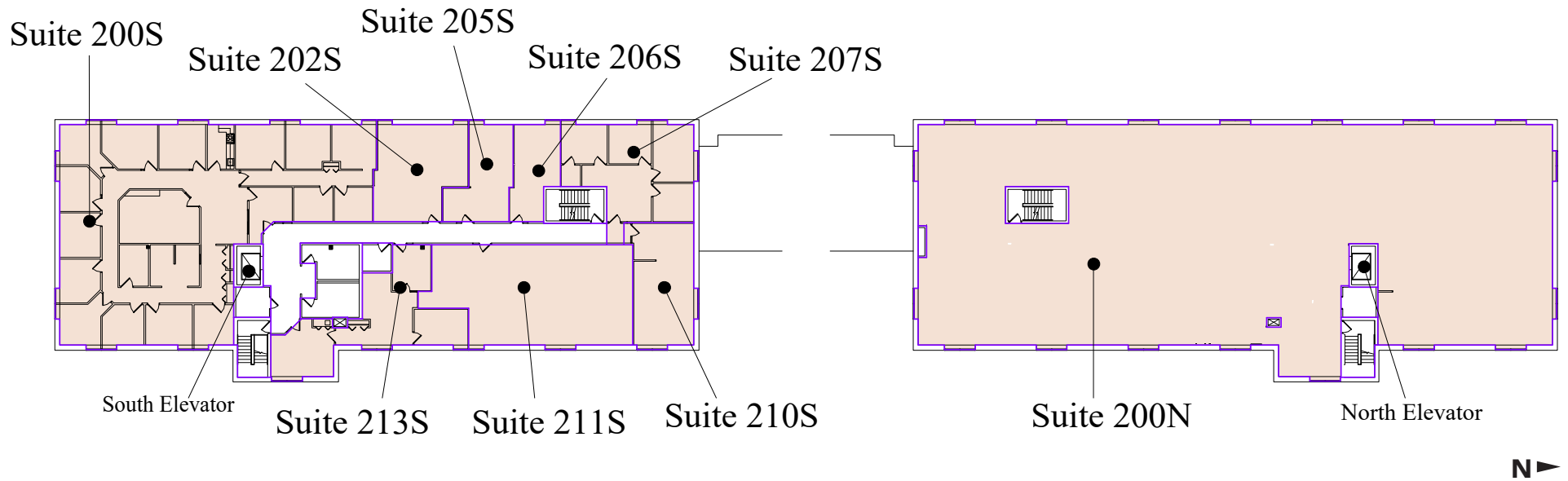

Floor Plan - Third Floor

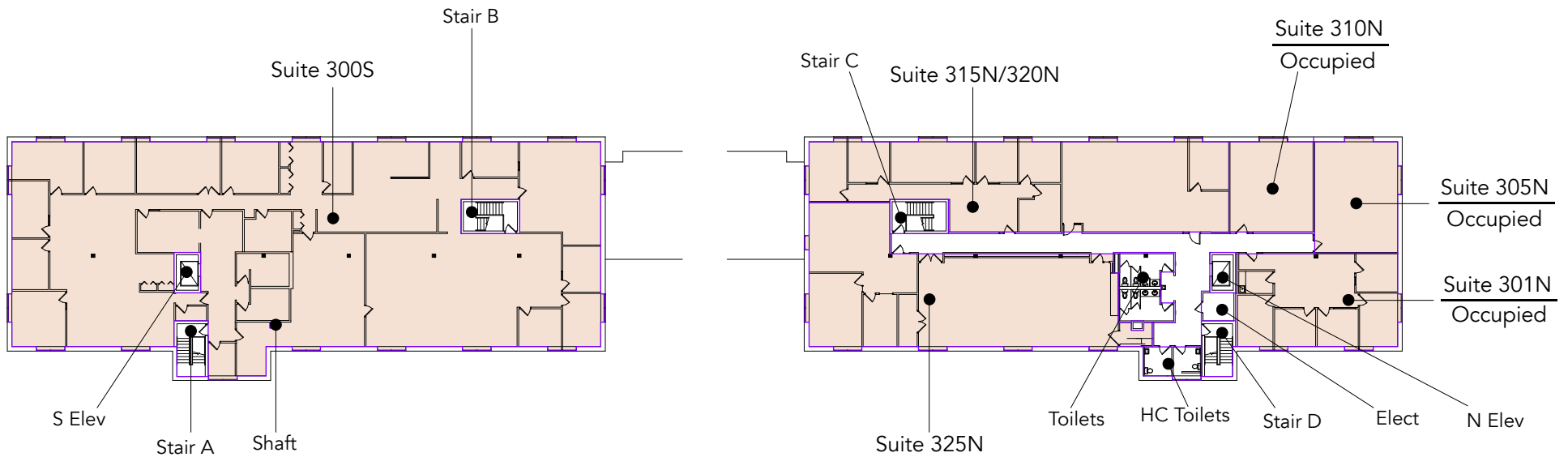

Site Plan

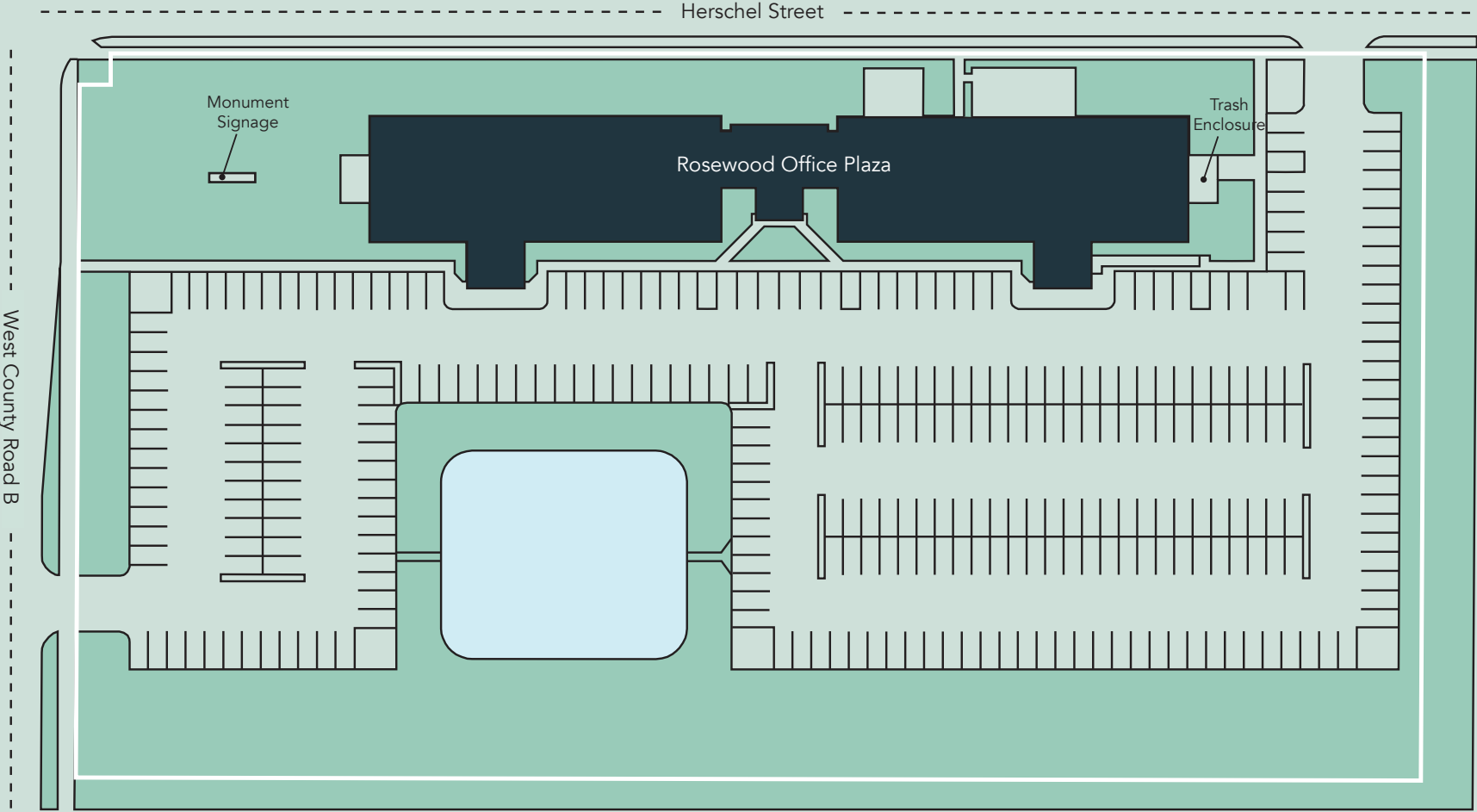

The Neighborhood

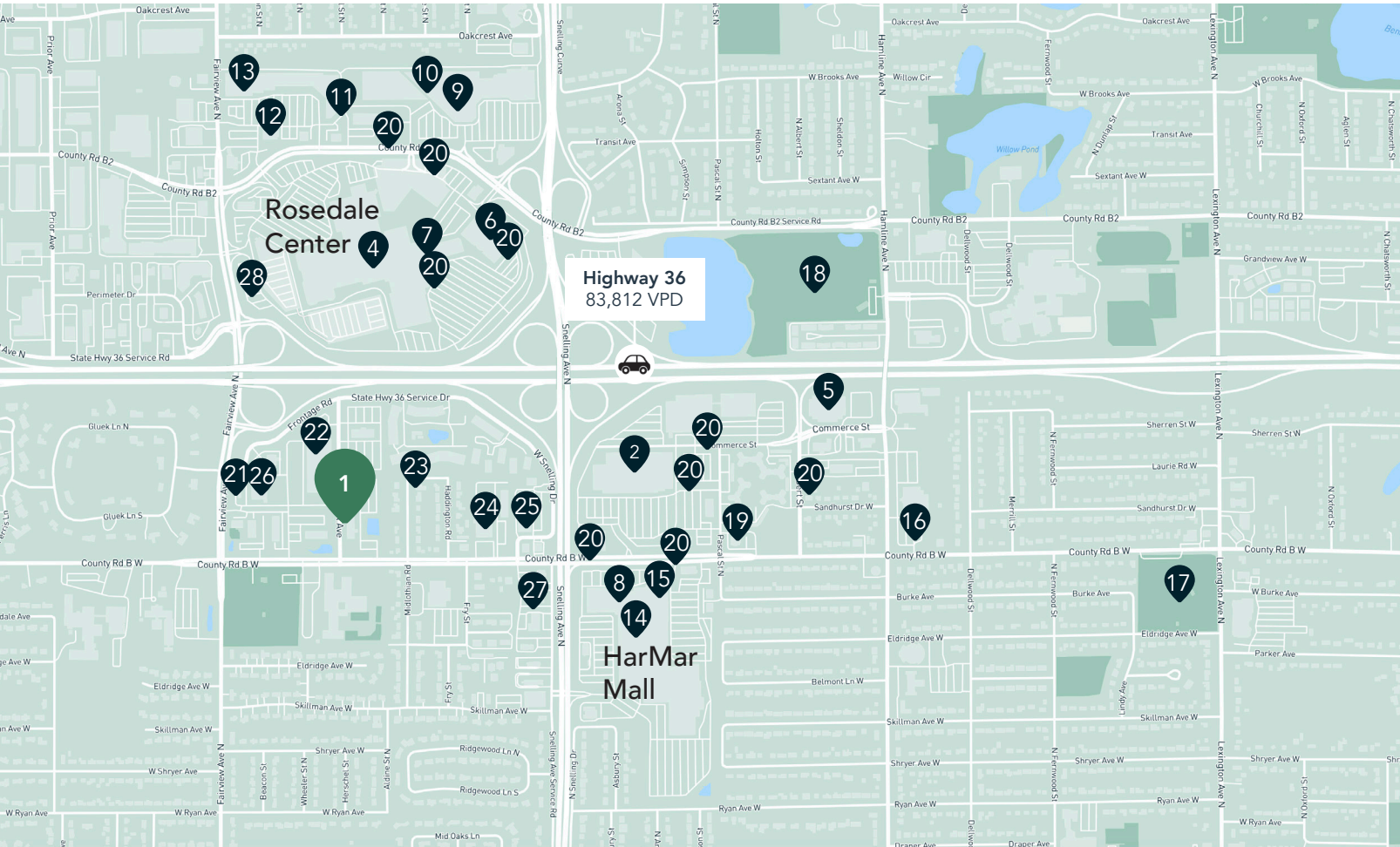

Demographics

1 MILE AWAY

7,574 Population
3,265 Households
\$145,445 Avg. Income

3 MILES AWAY

85,851 Population
36,000 Households
\$136,945 Avg. Income

5 MILES AWAY

372,899 Population
153,167 Households
\$120,664 Avg. Income



Hot Spots

- | | | | | | |
|----------------------------|----------------------------|------------------------|-------------------------------------|-----------------------------------|------------------|
| 1. Rosewood Office Plaza | 6. Rosedale Transit Center | 11. Lucky's 13 Pub | 16. Speedway | 21. Starbucks | 26. Market Fresh |
| 2. Target, Starbucks & CVS | 7. CRAVE American Kitchen | 12. Buffalo Wild Wings | 17. Lexington Park | 22. Planet Fitness | 27. Caribou |
| 3. HarMar Mall | 8. Kyoto Sushi | 13. Bed Bath & Beyond | 18. Roseville Cedarholm Golf Course | 23. Binie Teriyaki | 28. PNC Bank |
| 4. Rosedale Center | 9. Kohl's | 14. Chick-Fil-A | 19. Huntington Bank | 24. Goodwill | |
| 5. Macy's | 10. Noodles and Company | 15. D'Amico & Sons | 20. Bus stop | 25. Million's Crab Boiled Seafood | |

Rosewood Office Plaza

1711 West County Road B
Roseville, MN 55113



PROPERTY MANAGER
LEASING AGENT

Patrick Kyle

651-999-5529
pkyle@wellingtonmgt.com



St. Paul-based Wellington Management, Inc. owns, manages and develops commercial and residential properties throughout the Twin Cities metro area. We work to make long-term community impact through careful district planning and neighborhood relationships.



Main (651) 292-9844
Fax (651) 292-0072
wellingtonmgt.com

Wellington Management © 2021 All rights reserved.