

Valley Creek Mall & Annex

1740 & 1750 Weir Drive
Woodbury, MN 55125



WELLINGTON
MANAGEMENT



Claudia Ramirez
651-999-5561
cramirez@wellingtonmgt.com



Destination shopping center with a local focus.

Valley Creek Mall is Woodbury's only indoor shopping center and a longtime community anchor. Wellington acquired the two-building complex (an indoor mall and a strip mall) in 1994 and completed an extensive renovation to revitalize the mall, originally built in the '70s. Today, Valley Creek Mall is home to 25+ retail tenants, with a strong presence of locally owned and operated businesses.

These small businesses bring both unique offerings and a high level of service to the area. Keys Café remains Minnesota's most-awarded family-owned café and bakery, Frattallone's Hardware has served Woodbury for many years, and local, family-owned Warners' Stellan offers an array of home appliances and exceptional customer service. As of 2020, family-owned "community kitchen" Andiamo serves fine Italian cuisine in a beautifully outfitted space.

HIGHLIGHTS

- Well-established community anchor with 25+ retail tenants
- Located at the intersection of Valley Creek Road and I-494
- Anchor tenants include Frattallone's Hardware, Keys Café and Bakery, Andiamo, Warners' Stellan, Birdi Golf and Minnesota School of Cosmetology
- More than 30 events each year sponsored by active merchants association

Space Available

Owner, Manager, Leasing

96,048 SF; 6,877 SF available

500 surface stalls, 5.2 : 1,000 SF

Single-story retail buildings

Built in 1974 & 1985

East Metro

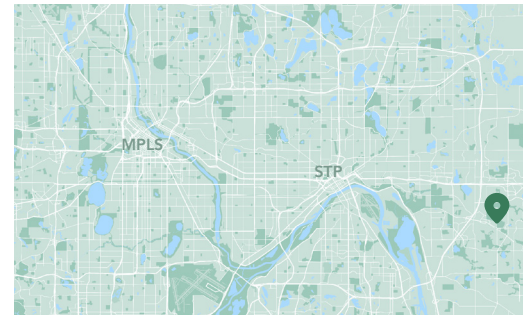

Available Suites



Suite 6 (Mall) - 3,252 SF



Suite 7 (Mall) - 1,914 SF

3D Tour 



Suite 26 (Annex) - 1,711 SF

3D Tour 

Floor Plans - Mall

- Building Common Areas
- Available Space
- Occupied Space

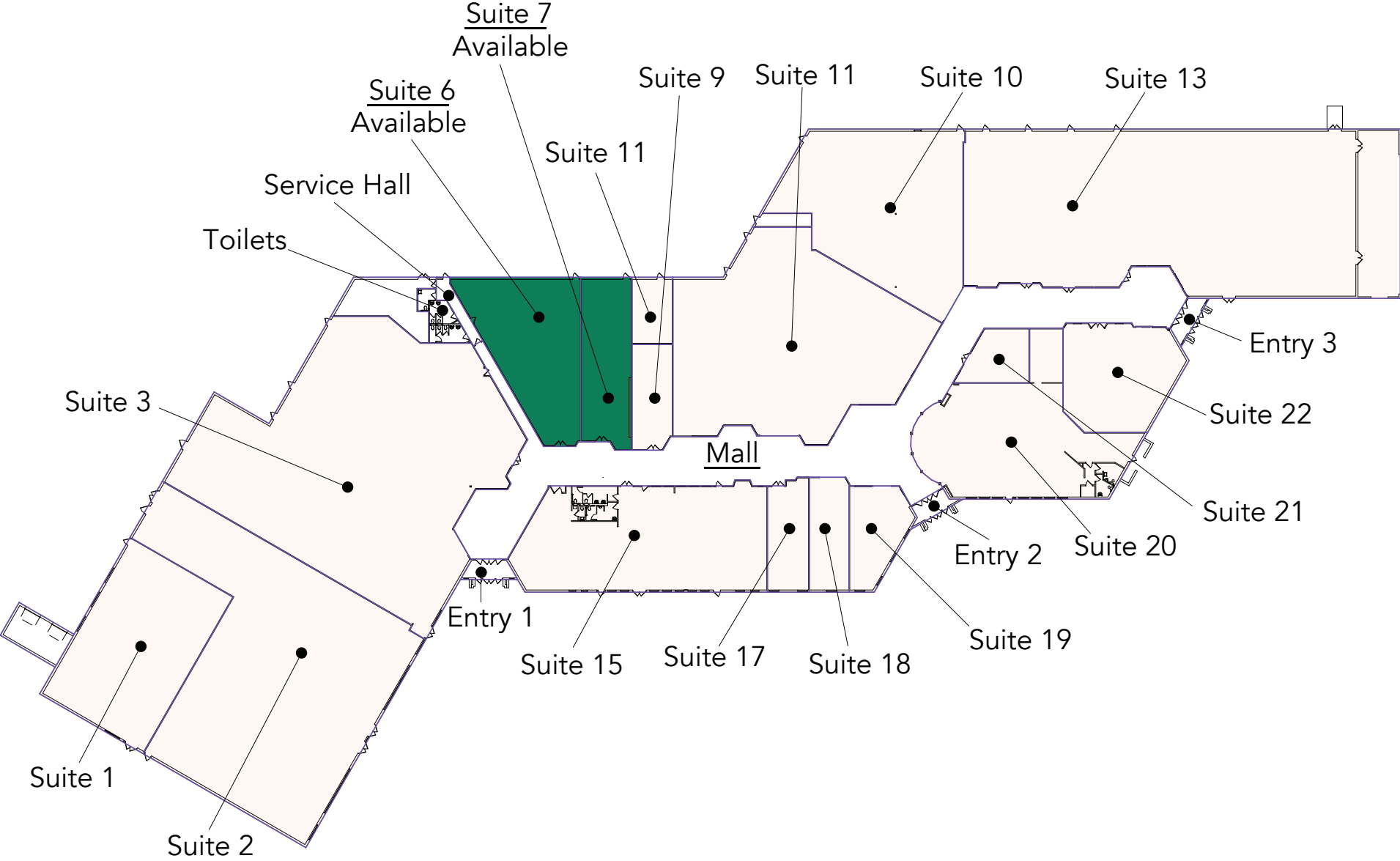

Floor Plans - Annex

- Building Common Areas
- Available Space
- Occupied Space

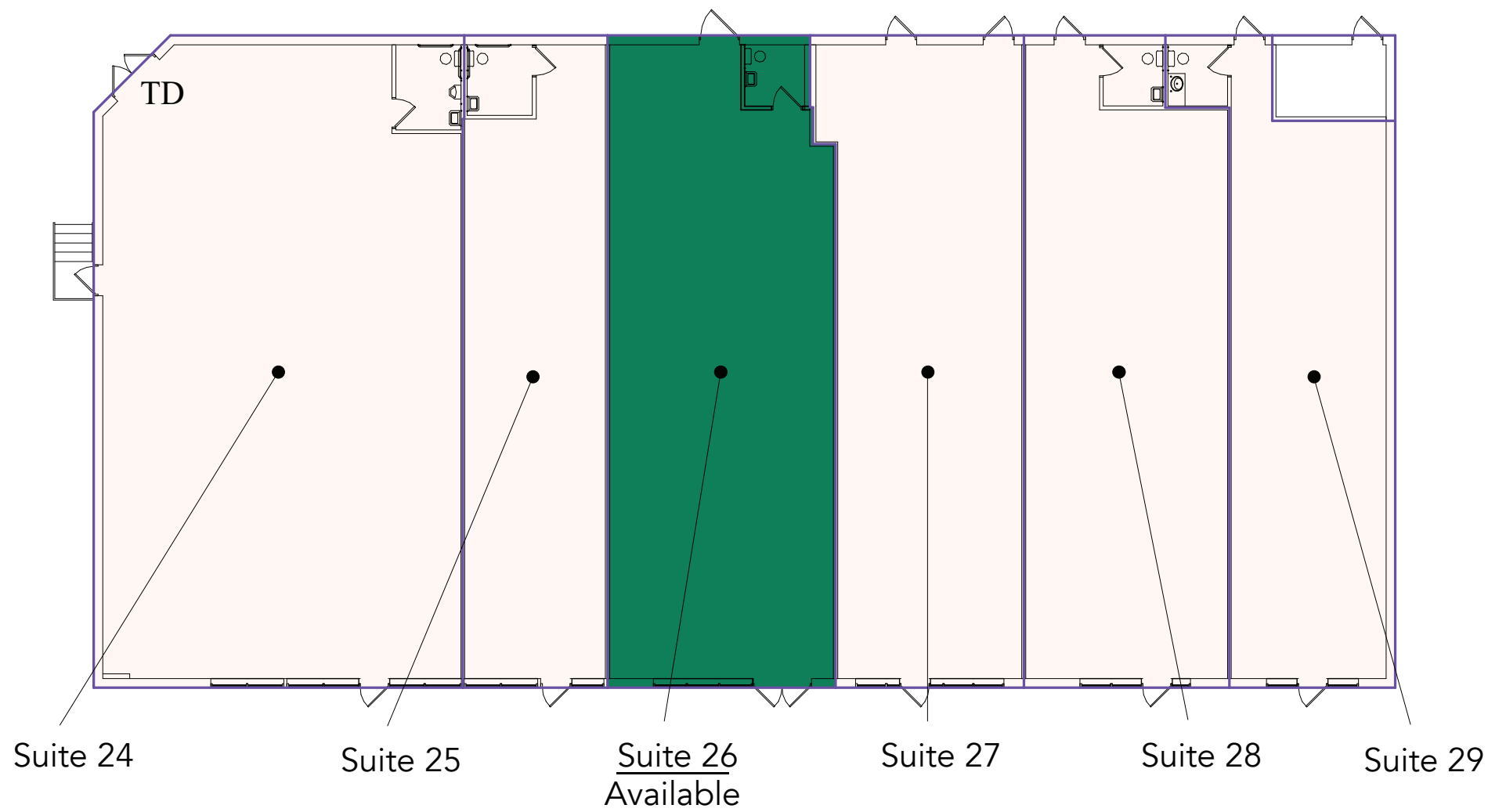

Site Plan

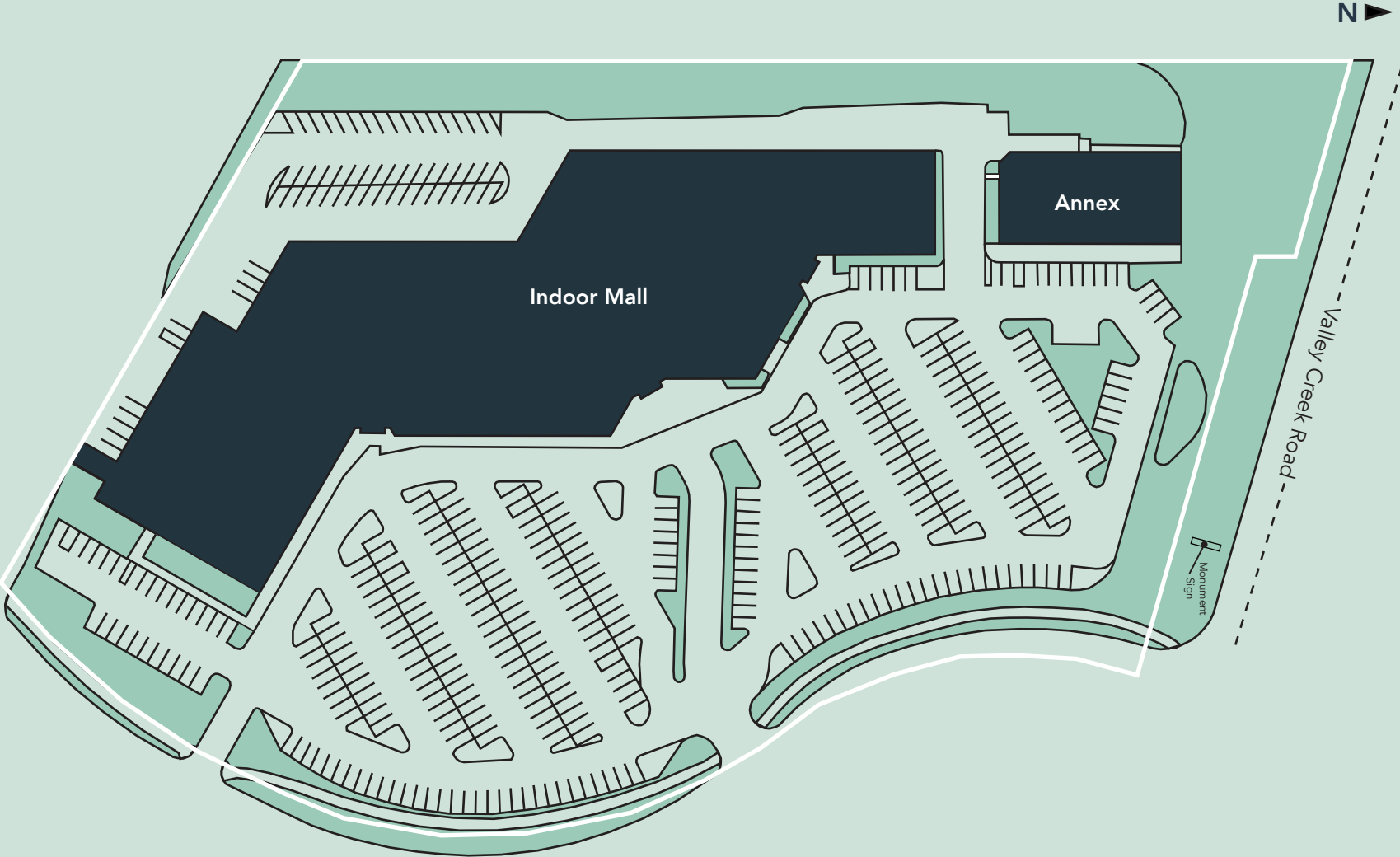

The Neighborhood



Hot Spots

1. Valley Creek Mall & Annex
2. Summit Orthopedics
3. The Urgency Room
4. City Centre
5. Woodwinds Hospital
6. Hampton Inn
7. Woodbury Village
8. Woodbury 10 Theater
9. Woodbury Middle School
10. Woodbury Elementary

Demographics	1 MILE	3 MILES	5 MILES
POPULATION	7,638	70,276	209,478
HOUSEHOLDS	3,168	27,461	76,466
AVG. INCOME	\$120,096	\$133,055	\$132,556

Valley Creek Mall & Annex

1740 & 1750 Weir Drive
Woodbury, MN 55125



PROPERTY MANAGER
LEASING AGENT

Claudia Ramirez

651-999-5561
cramirez@wellingtonmgt.com



WELLINGTON
MANAGEMENT

St. Paul-based Wellington Management, Inc. owns, manages and develops commercial and residential properties throughout the Twin Cities metro area. We work to make long-term community impact through careful district planning and neighborhood relationships.

Main (651) 292-9844
Fax (651) 292-0072
wellingtonmgt.com

Wellington Management © 2021 All rights reserved.