

BANDANA SQUARE

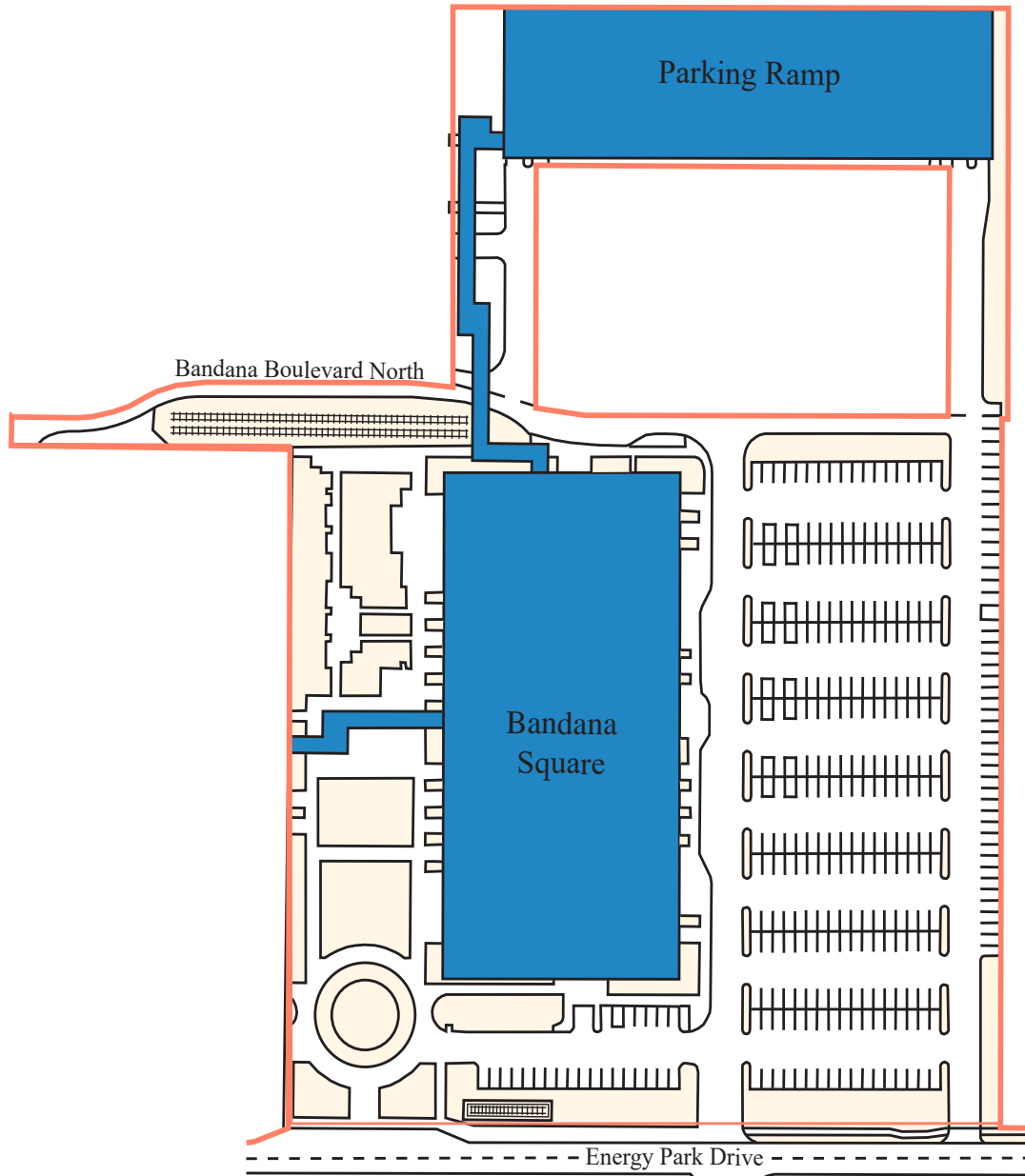





1021 Bandana Boulevard East, St. Paul, MN 55108

SITE PLAN



PROPERTY HIGHLIGHTS

- Historic brick and timber office building with modern infrastructure and energy management systems
- Common area conference room
- Skyway connection to adjacent hotel & parking ramp
- Fiber optic and cable connectivity
- 12' ceilings
- Conveniently located with easy access to local shops, restaurants and public transportation
- Listed on the National Register of Historic Places

-  Parking Lot/Sidewalk
-  Building
-  Landscape
-  Property Line

ADDRESS	1021 Bandana Boulevard East, St. Paul, MN 55108
BUILDING AREA	140,000 SF
NUMBER OF STORIES	2
PARKING STALLS	Surface: 326 North Ramp: 450
CLEAR HEIGHT	12'
YEAR BUILT	1890s - Redeveloped in 1980s



|FLOOR PLANS

FIRST FLOOR

72,700 SF

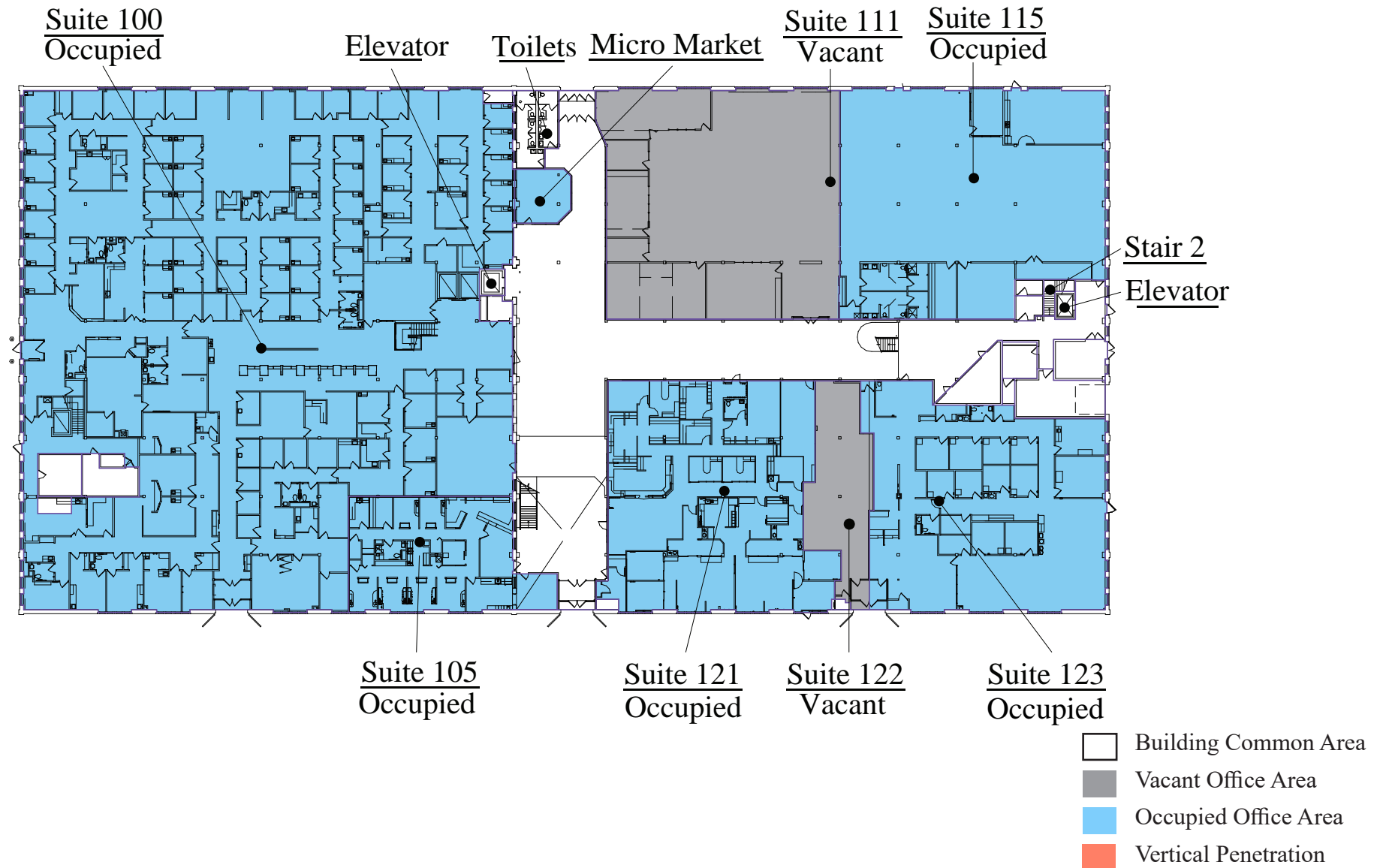



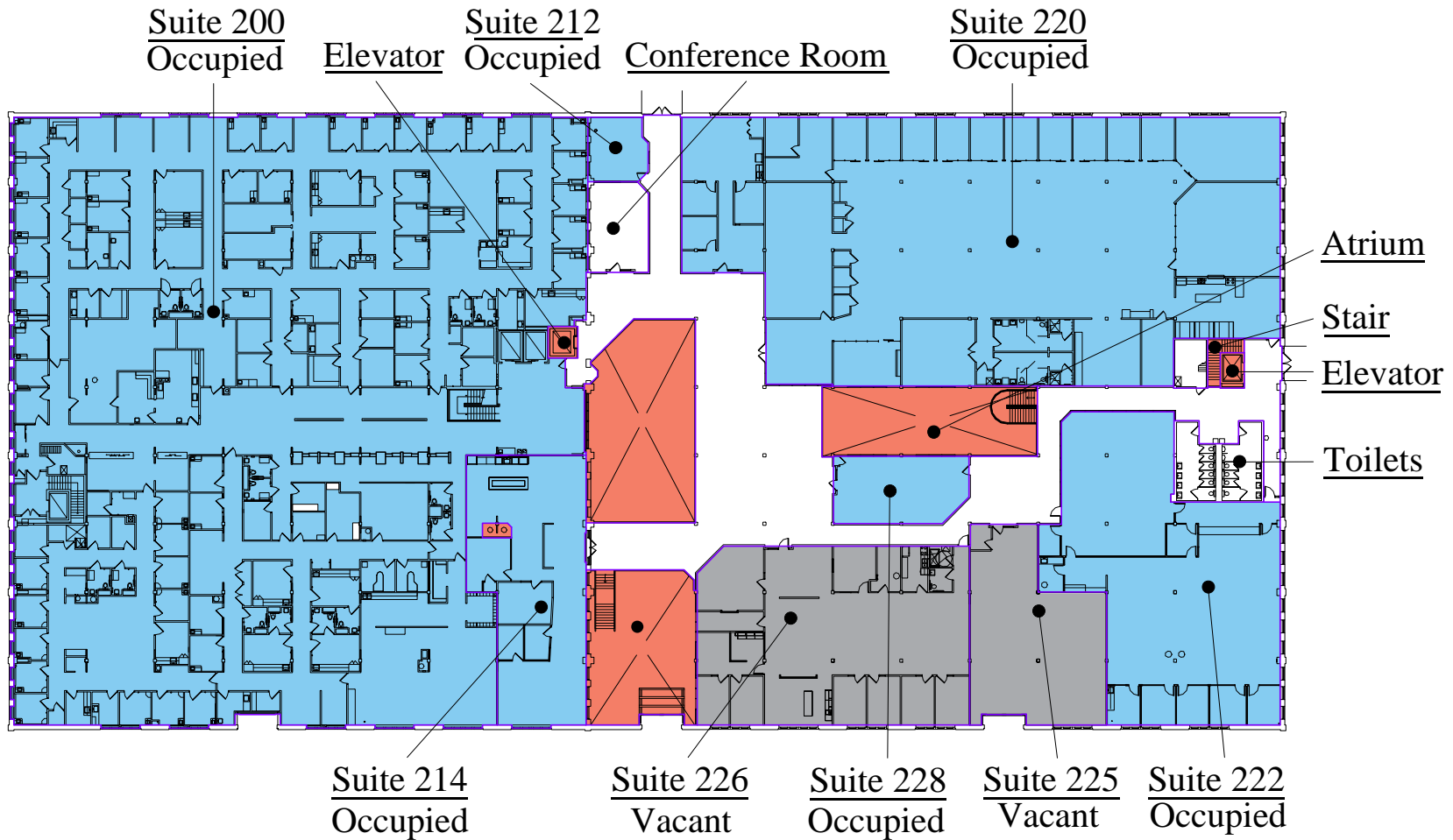

FLOOR PLANS

SECOND FLOOR

67,300 SF



-  Building Common Area
-  Vacant Office Area
-  Occupied Office Area
-  Vertical Penetration

AREA DEMOGRAPHICS

	1 MILE	3 MILES	5 MILES
POPULATION	16,418	155,763	401,931
HOUSEHOLDS	6,895	62,961	160,414
HOUSEHOLD INCOME	\$69,436	\$76,999	\$74,017

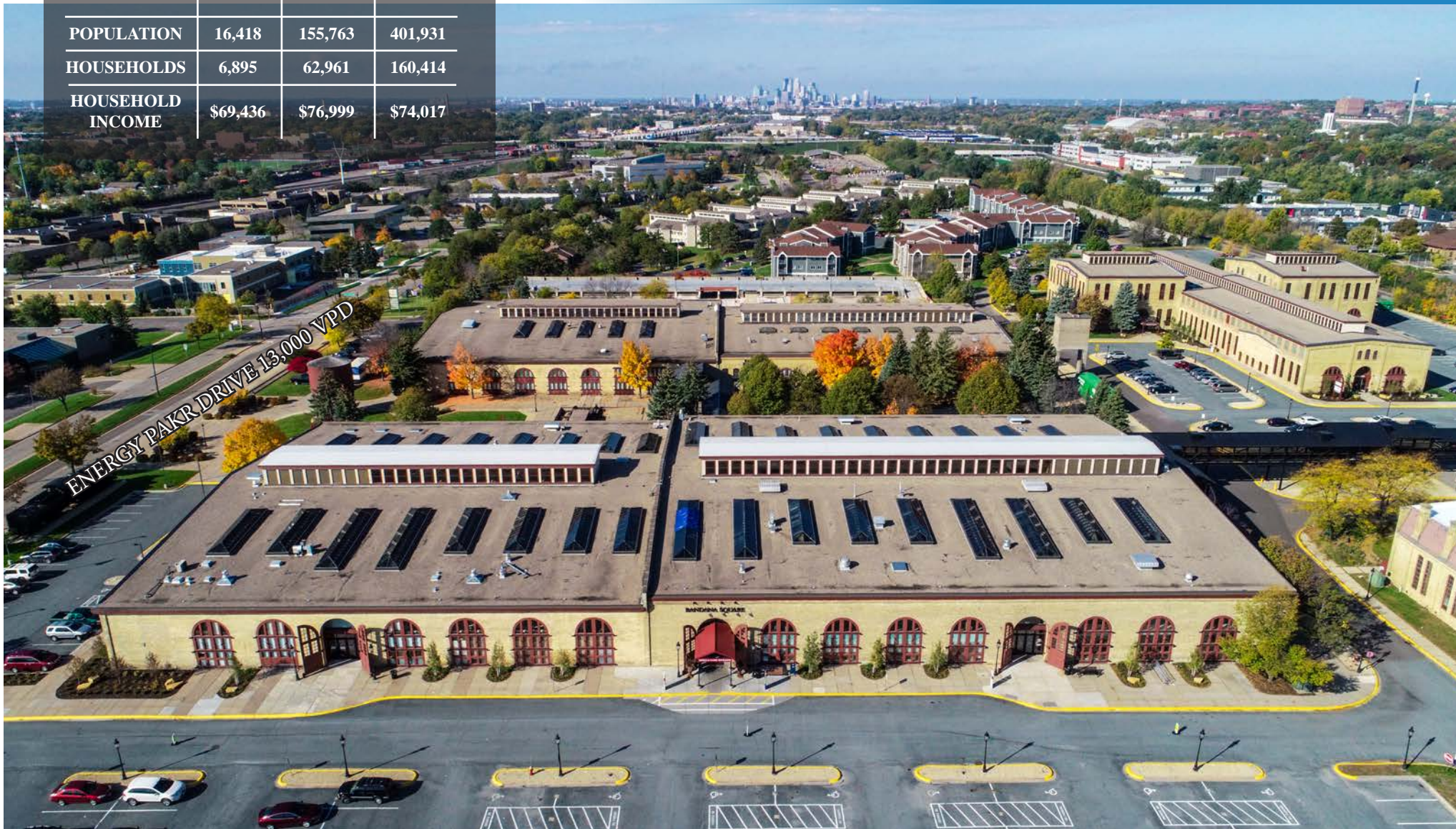

CONTACTS

Pat Kyle

Property Manager & Leasing Agent
(651) 999-5529 Direct
pkyle@wellingtonmgt.com

Judy Olson

Customer Service & Property Administrator
(651) 999-5541 Direct
(651) 999-5516 Customer Service
jolson@wellingtonmgt.com

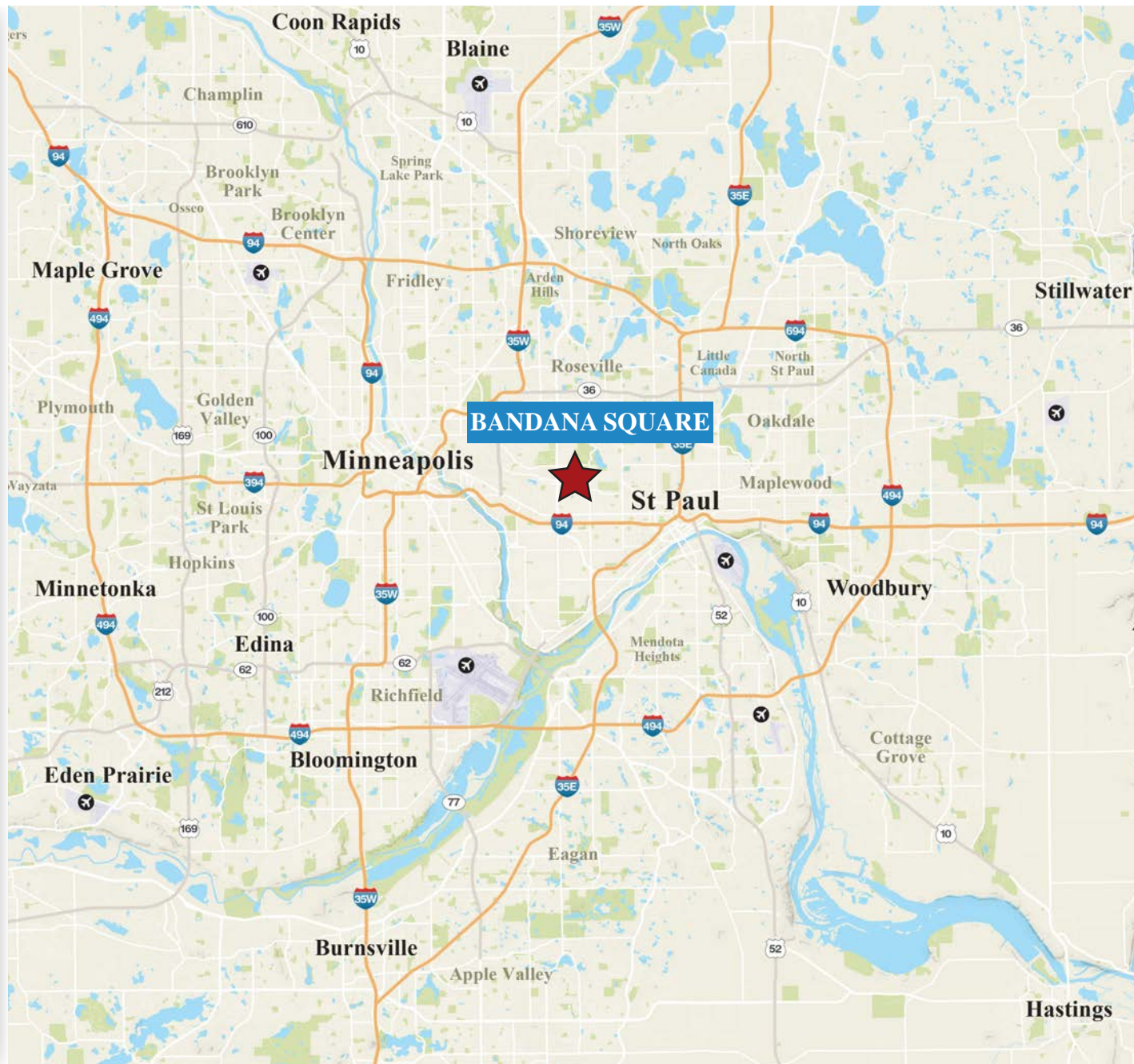

1625 Energy Park Drive, Suite 100, St. Paul, MN 55108 | Main (651) 292-9844 | Fax (651) 292-0072 | wellingtonmgt.com