

LYNDALE STATION







6501-6555 Lyndale Avenue South, Richfield, MN 55423

SITE PLAN

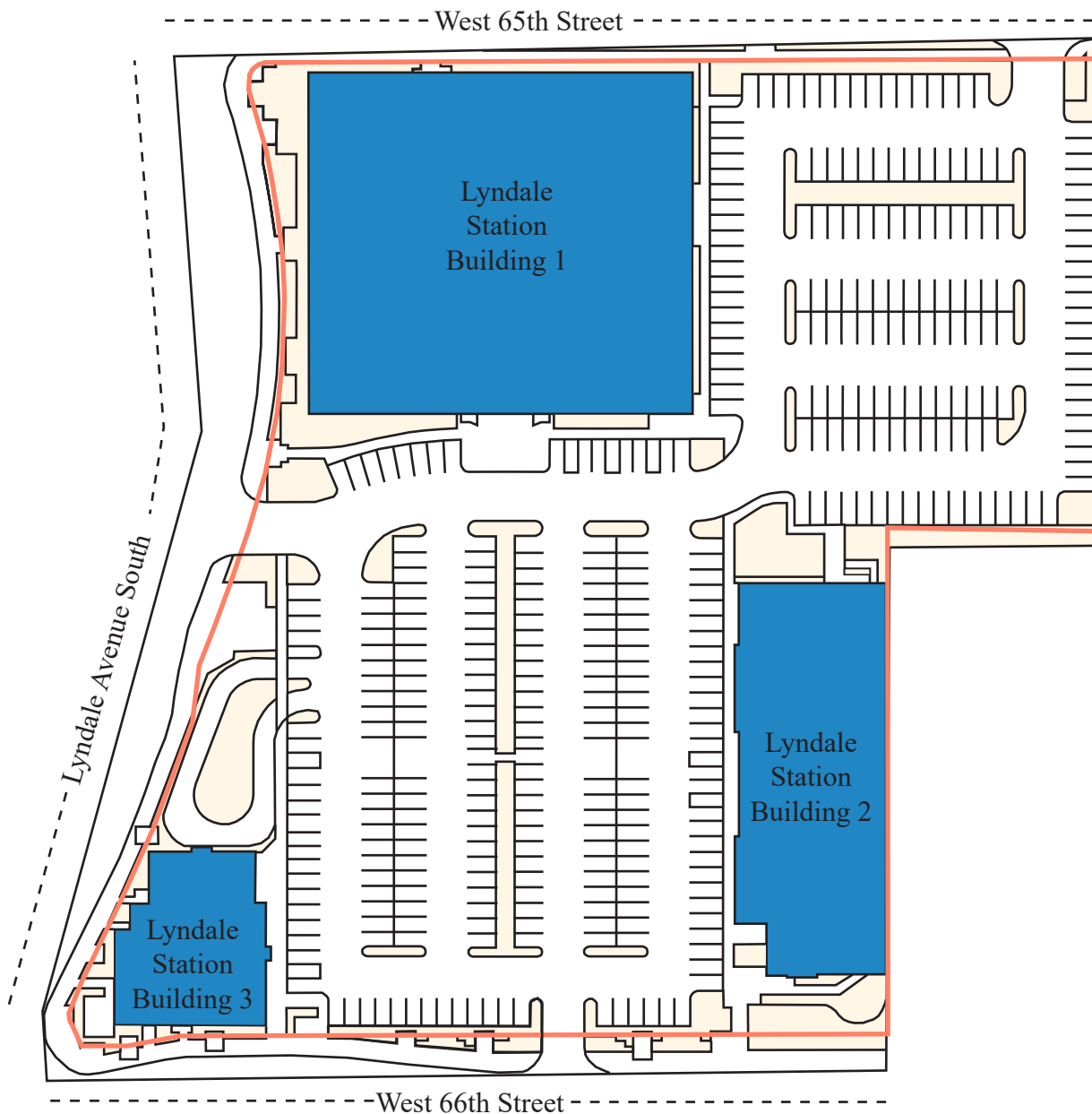
PROPERTY HIGHLIGHTS

- Newly-built facility in a convenient location
- Located at the intersection of 66th Street and Lyndale Avenue



-  Parking Lot/Sidewalk
-  Building
-  Landscape
-  Property Line

	Building 1	Building 2	Building 3
ADDRESS	6501 Lyndale Avenue South Richfield, MN 55423	6501-6545 Lyndale Avenue South Richfield, MN 55423	6545-6555 Lyndale Avenue South Richfield, MN 55423
BUILDING AREA	45,000 SF	19,700 SF	8,500 SF
NUMBER OF STORIES	1	1	1
PARKING STALLS	-	Retail Center - 400 Stalls	
CLEAR HEIGHT	23'7"	17'2"	12'
YEAR BUILT	2012	2012	2015



FLOOR PLANS

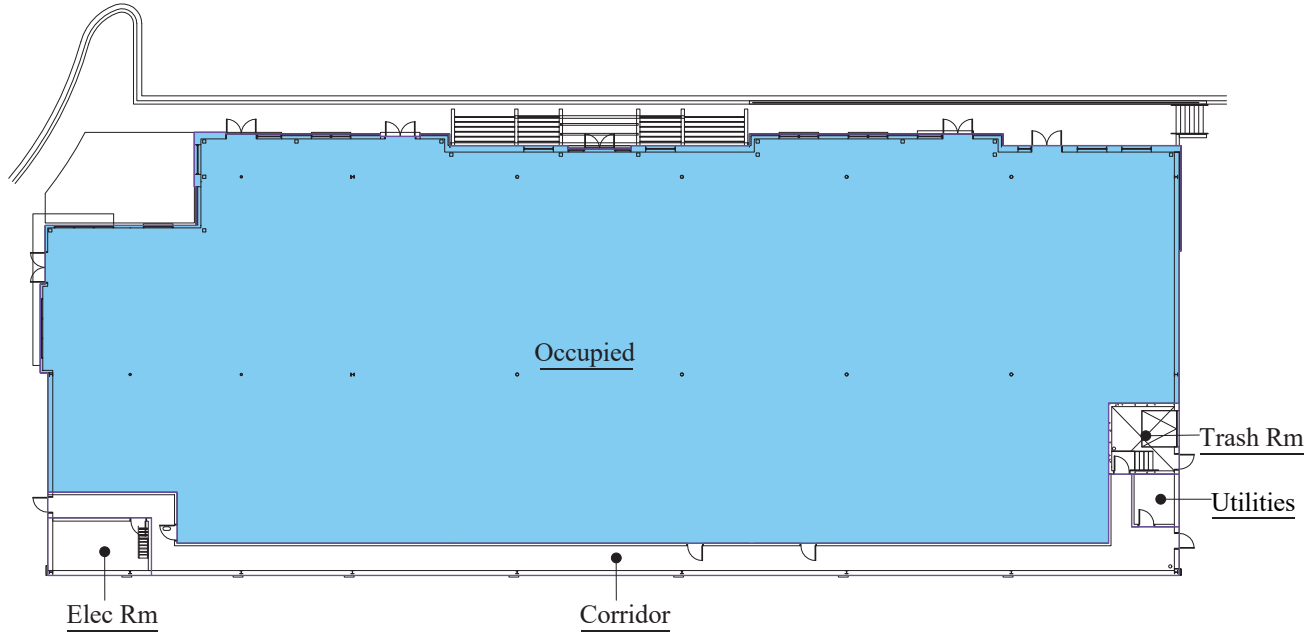



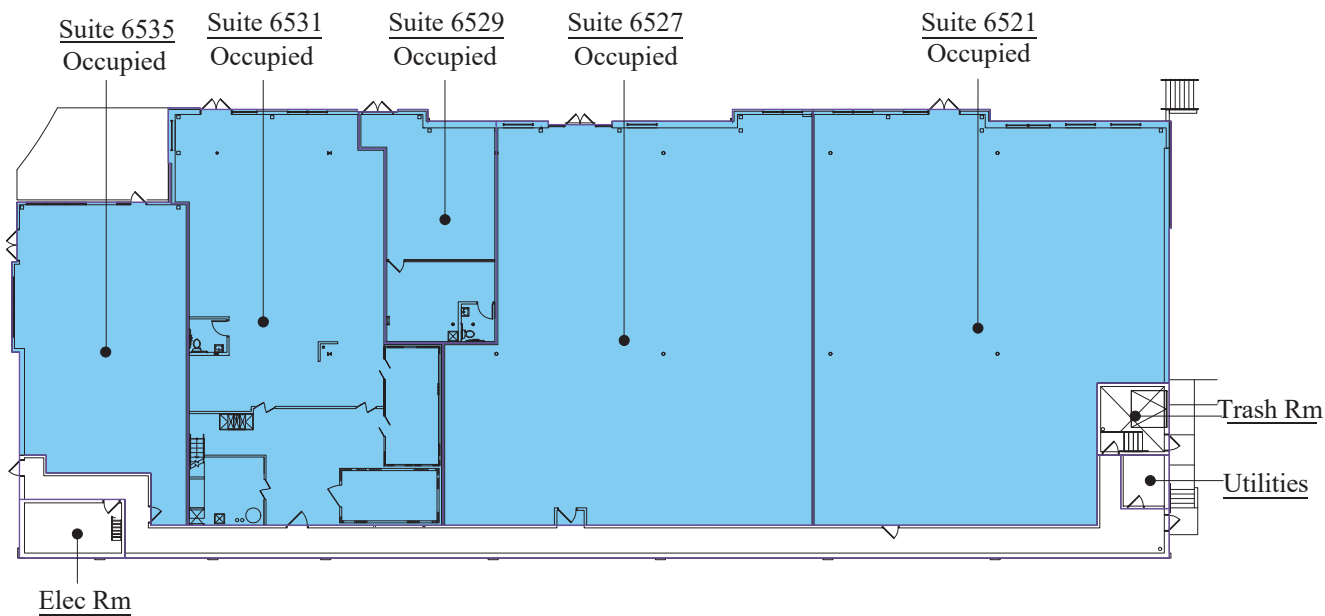

BUILDING ONE

45,000 SF



BUILDING TWO

19,700 SF

-  Building Common Area
-  Vacant Retail Area
-  Occupied Retail Area
-  Vertical Penetration

FLOOR PLANS

BUILDING THREE

8,500 SF

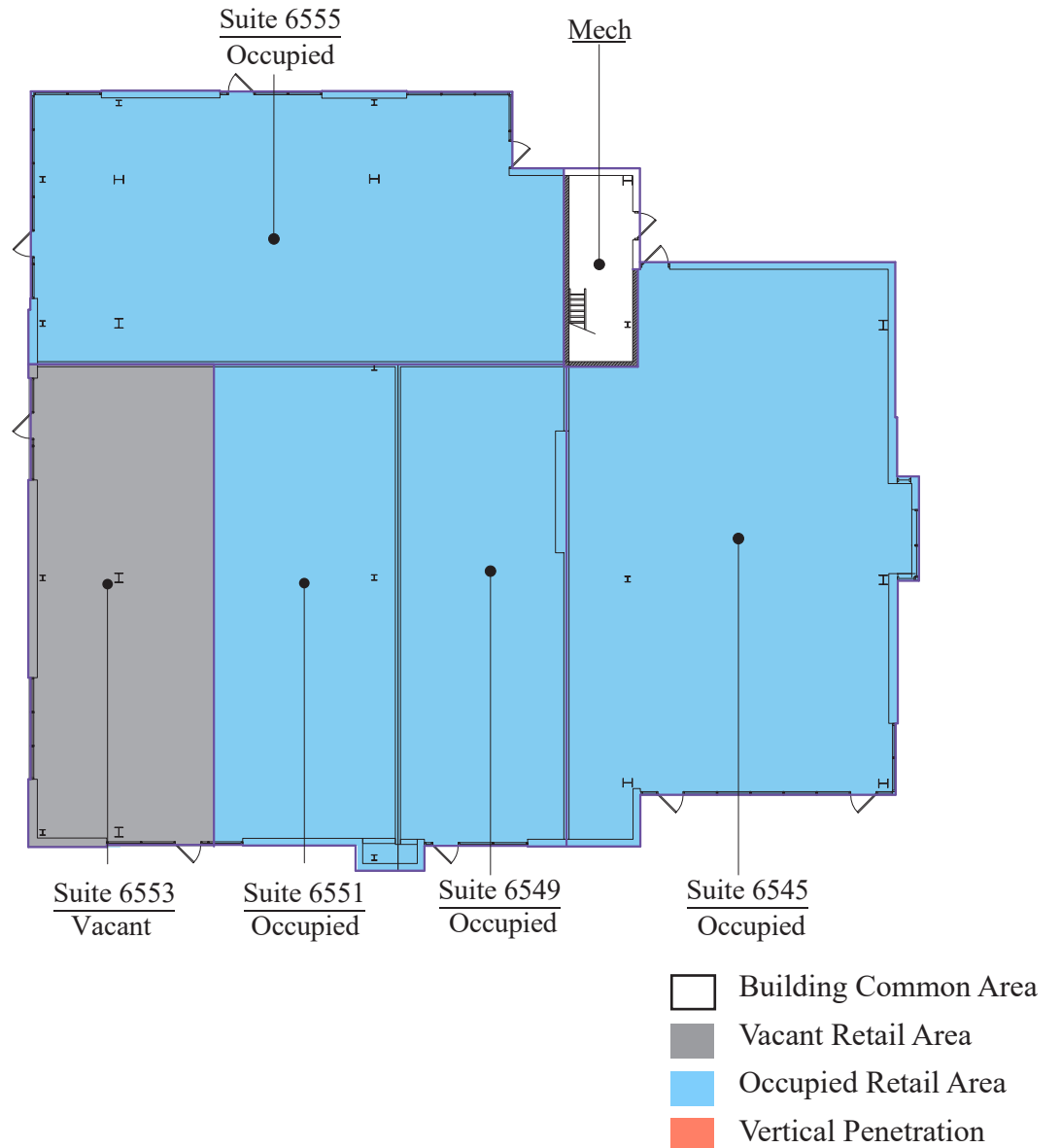

CONTACTS

Joe Houseman

Property Manager & Leasing Agent
(651) 999-5515 Direct
jhouseman@wellingtonmgt.com

Ashley Burdine

Customer Service & Property Administrator
(651) 999-5506 Direct
(651) 999-5516 Customer Service
aburdine@wellingtonmgt.com

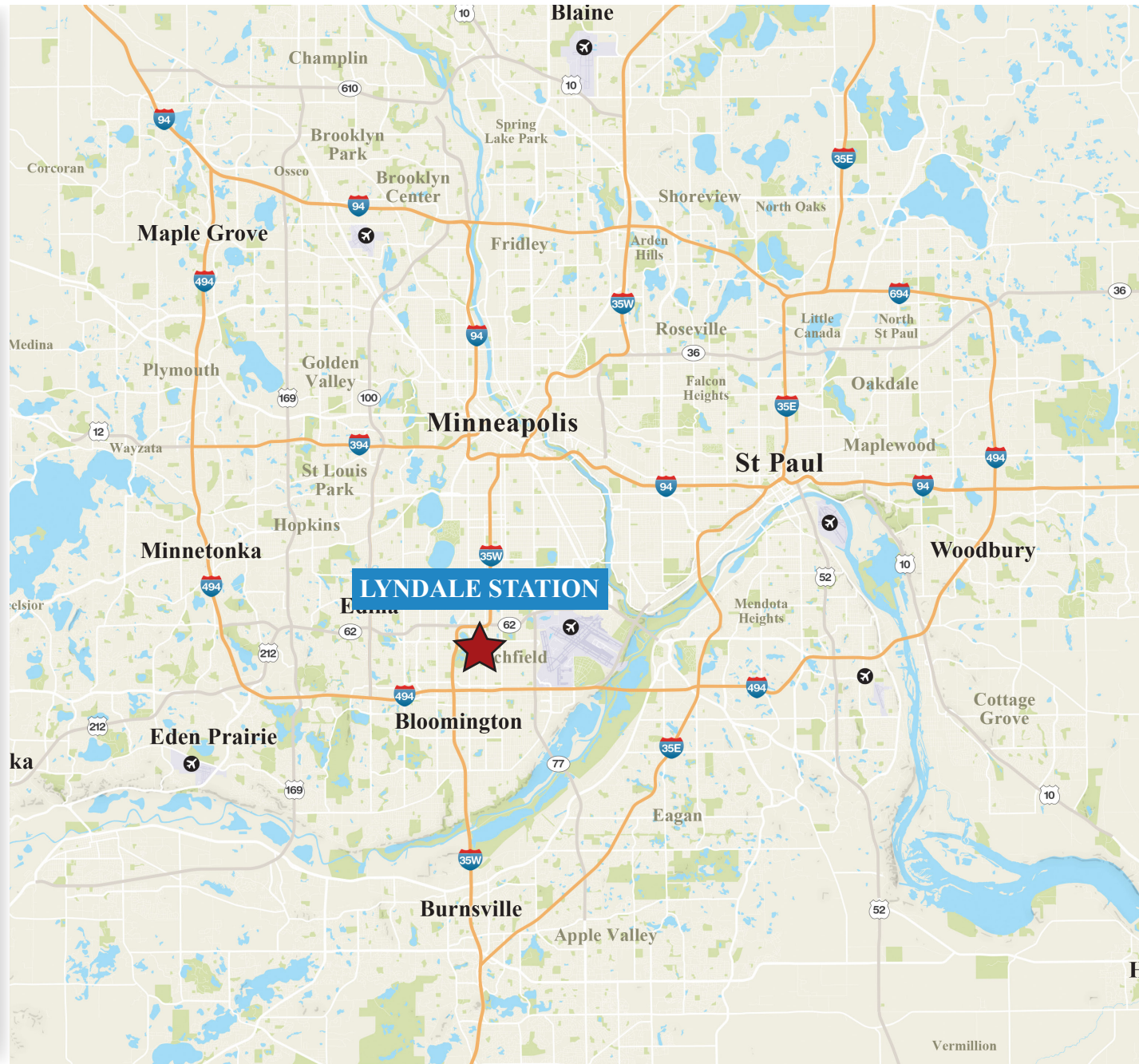

1625 Energy Park Drive, Suite 100, St. Paul, MN 55108 | Main (651) 292-9844 | Fax (651) 292-0072 | wellingtonmgt.com