

PLYMOUTH CORPORATE



2605 Fernbrook Lane North, Plymouth, MN 55447

SITE PLAN

PROPERTY HIGHLIGHTS

- Numerous food, retail and service amenities
- Easy access to downtown Minneapolis
- Highway 55, along the west side of I-494
- Monument signage along Fernbrook Lane North

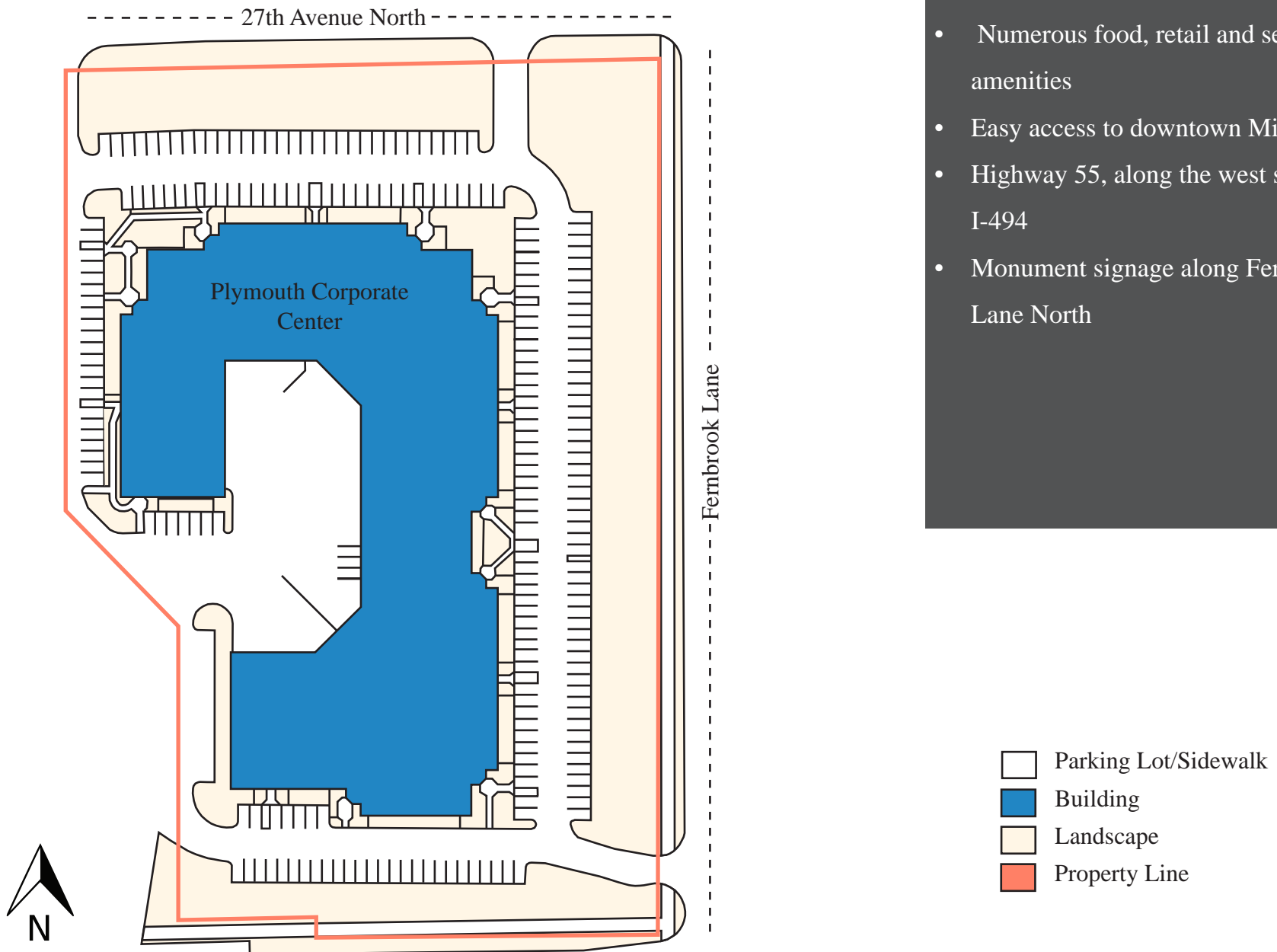





ADDRESS	2605 Fernbrook Lane North, Plymouth, MN 55447
BUILDING AREA	81,400 SF
NUMBER OF STORIES	1
PARKING STALLS	252 Stalls
CLEAR HEIGHT	16'
YEAR BUILT	1987



FLOOR PLANS

MAIN FLOOR

81,400 SF

-  Building Common Area
-  Vacant Office Area
-  Occupied Office Area
-  Vertical Penetration

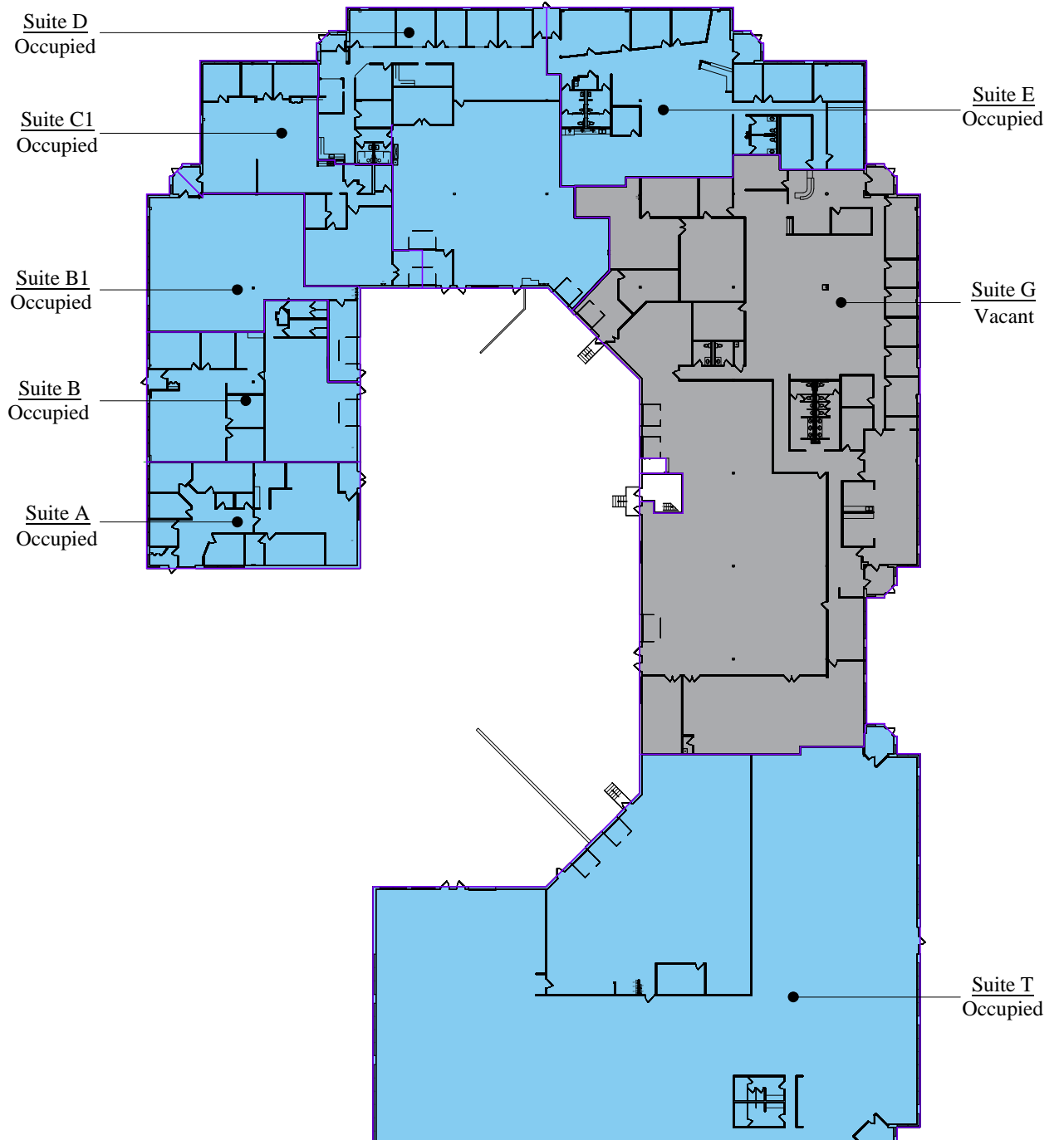



HIGHWAY 55 55,000 VPD

I-494 88,000 VPD

FERNBROOK LANE NORTH 11,700 VPD

AREA DEMOGRAPHICS

	1 MILE	3 MILES	5 MILES
POPULATION	5,419	61,702	156,279
HOUSEHOLDS	2,700	24,988	64,530
HOUSEHOLD INCOME	\$91,499	\$127,791	\$188,734

CONTACTS

Joe Houseman

Property Manager & Leasing Agent
(651) 999-5515 Direct
jhouseman@wellingtonmgt.com

Ashley Burdine

Customer Service & Property Administrator
(651) 999-5506 Direct
(651) 999-5516 Customer Service
aburdine@wellingtonmgt.com

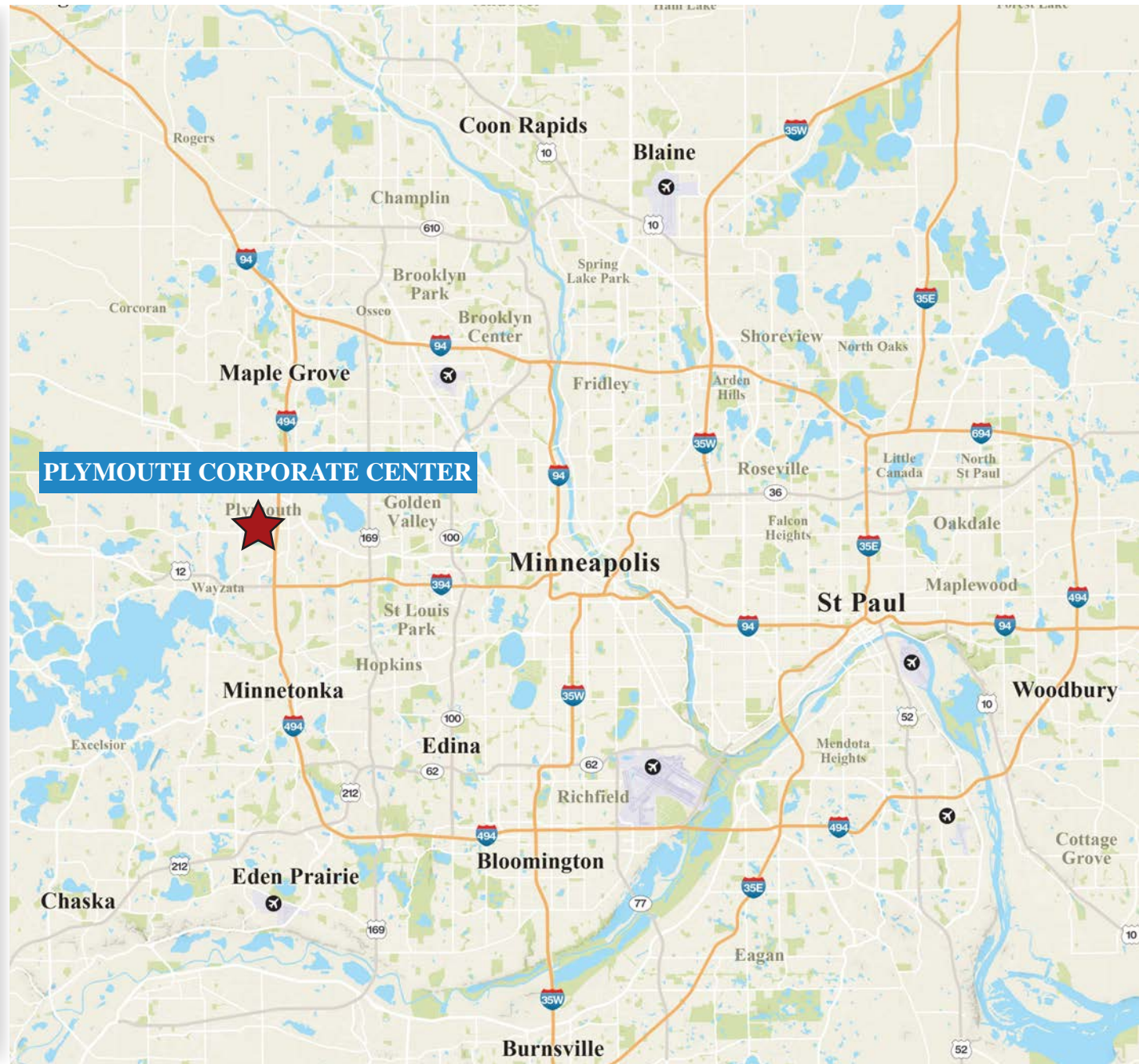

1625 Energy Park Drive, Suite 100, St. Paul, MN 55108 | Main (651) 292-9844 | Fax (651) 292-0072 | wellingtonmgt.com