

VALLEY CREEK COMMONS







8380 City Centre Drive, Woodbury, MN 55125

SITE PLAN

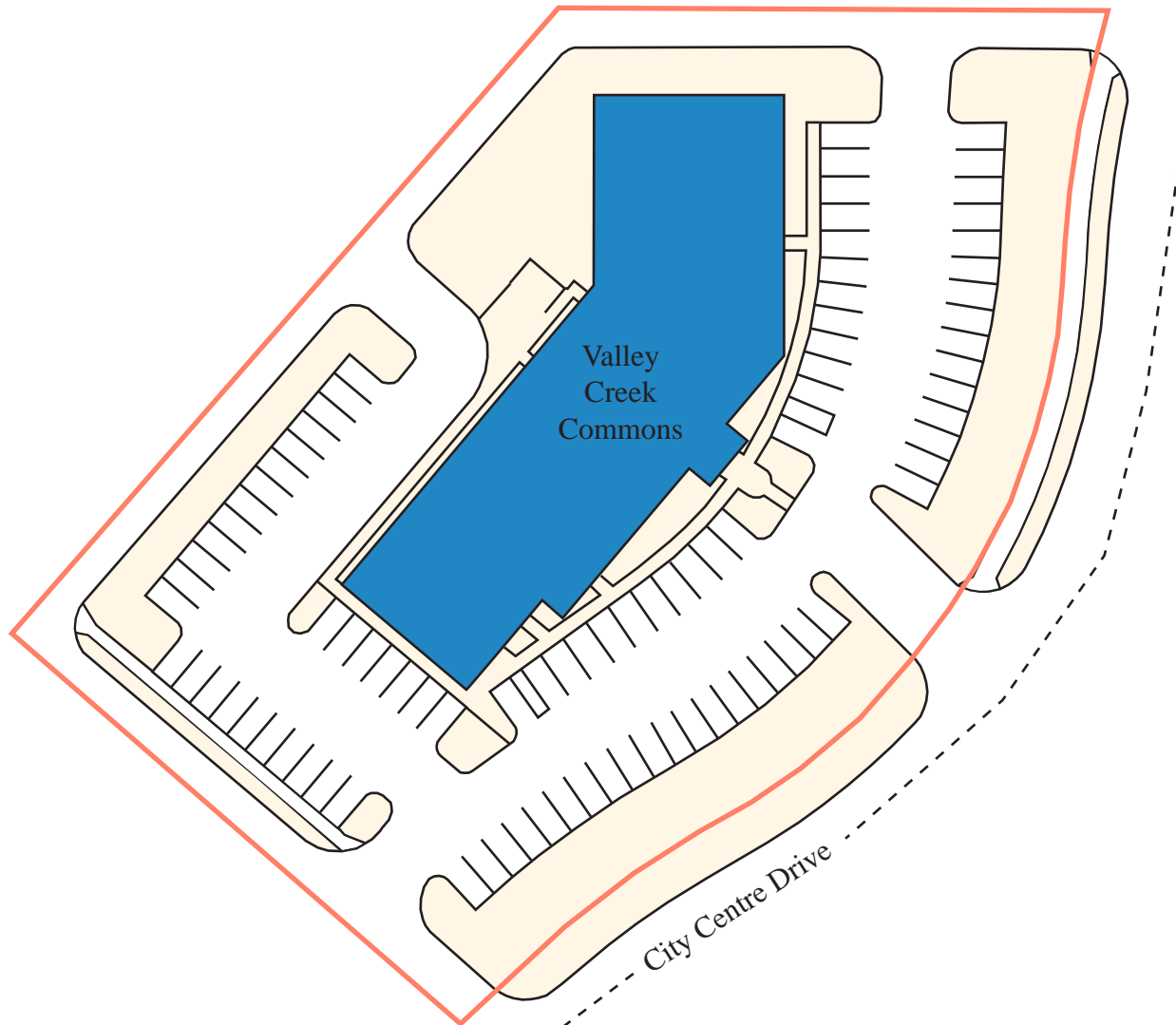
PROPERTY HIGHLIGHTS

- Newly remodeled common areas
- ADA compliant
- Conveniently located near banks, shopping and restaurants
- Updated exterior facade with building signage



-  Parking Lot/Sidewalk
-  Building
-  Landscape
-  Property Line



ADDRESS	8380 City Centre Drive, Woodbury, MN 55125
BUILDING AREA	16,200 SF
NUMBER OF STORIES	1
PARKING STALLS	89 Stalls
YEAR BUILT	1996



FLOOR PLANS

MAIN FLOOR 16,200 SF

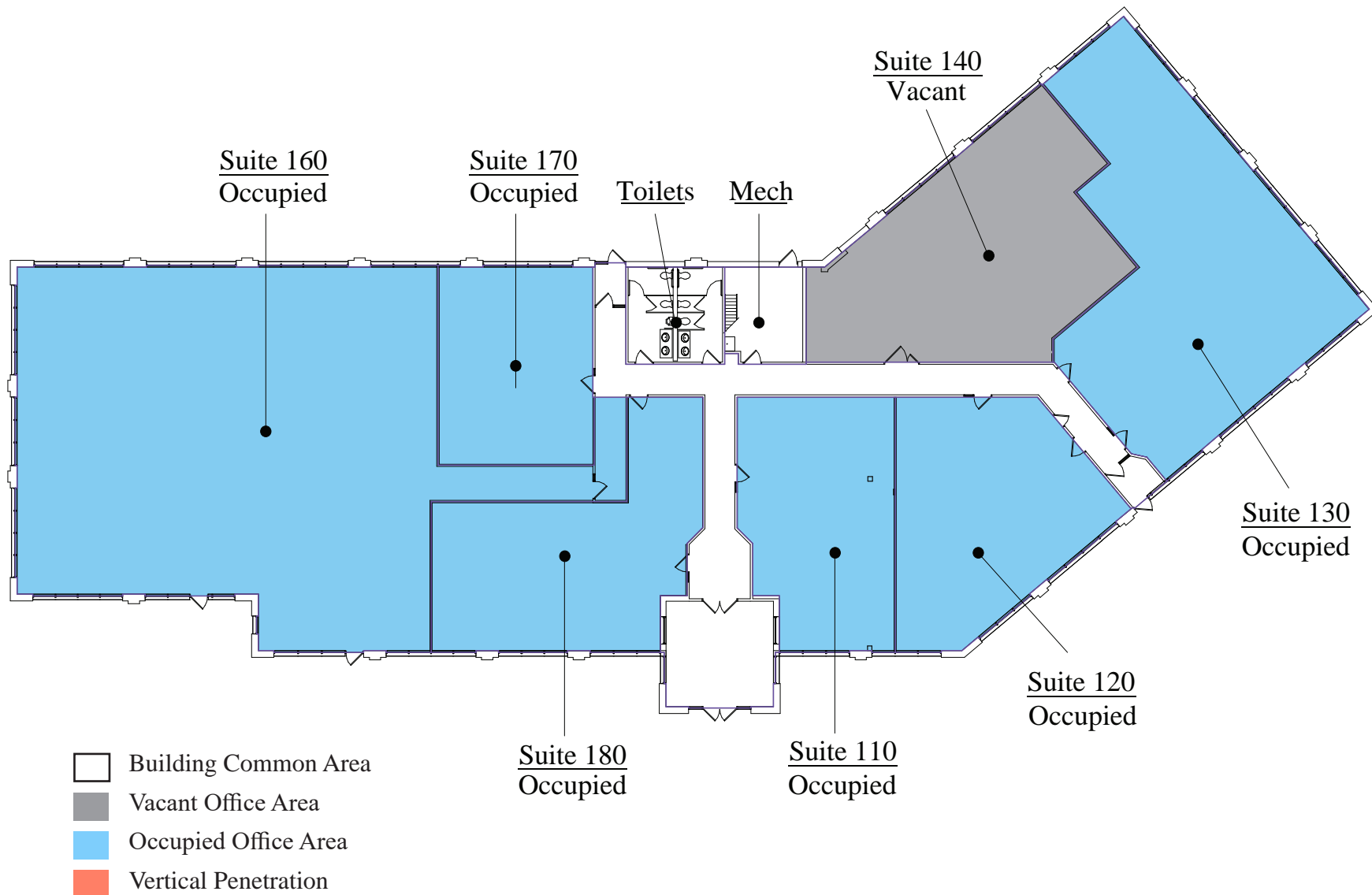

AREA DEMOGRAPHICS

	1 MILE	3 MILES	5 MILES
POPULATION	10,823	67,757	128,937
HOUSEHOLDS	3,985	24,919	47,773
HOUSEHOLD INCOME	\$126,568	\$126,092	\$110,436

VALLEY CREEK ROAD 23,300 VPD

CITY CENTRE DRIVE 4,350 VPD

RADIO DRIVE 26,200 VPD



CONTACTS

Kathy Bayliss, CPM, CCIM

Property Manager & Leasing Agent
(651) 999-5509 Direct
kbayliss@wellingtonmgt.com

Judy Olson

Customer Service & Property Administrator
(651) 999-5541 Direct
(651) 999-5516 Customer Service
jolson@wellingtonmgt.com

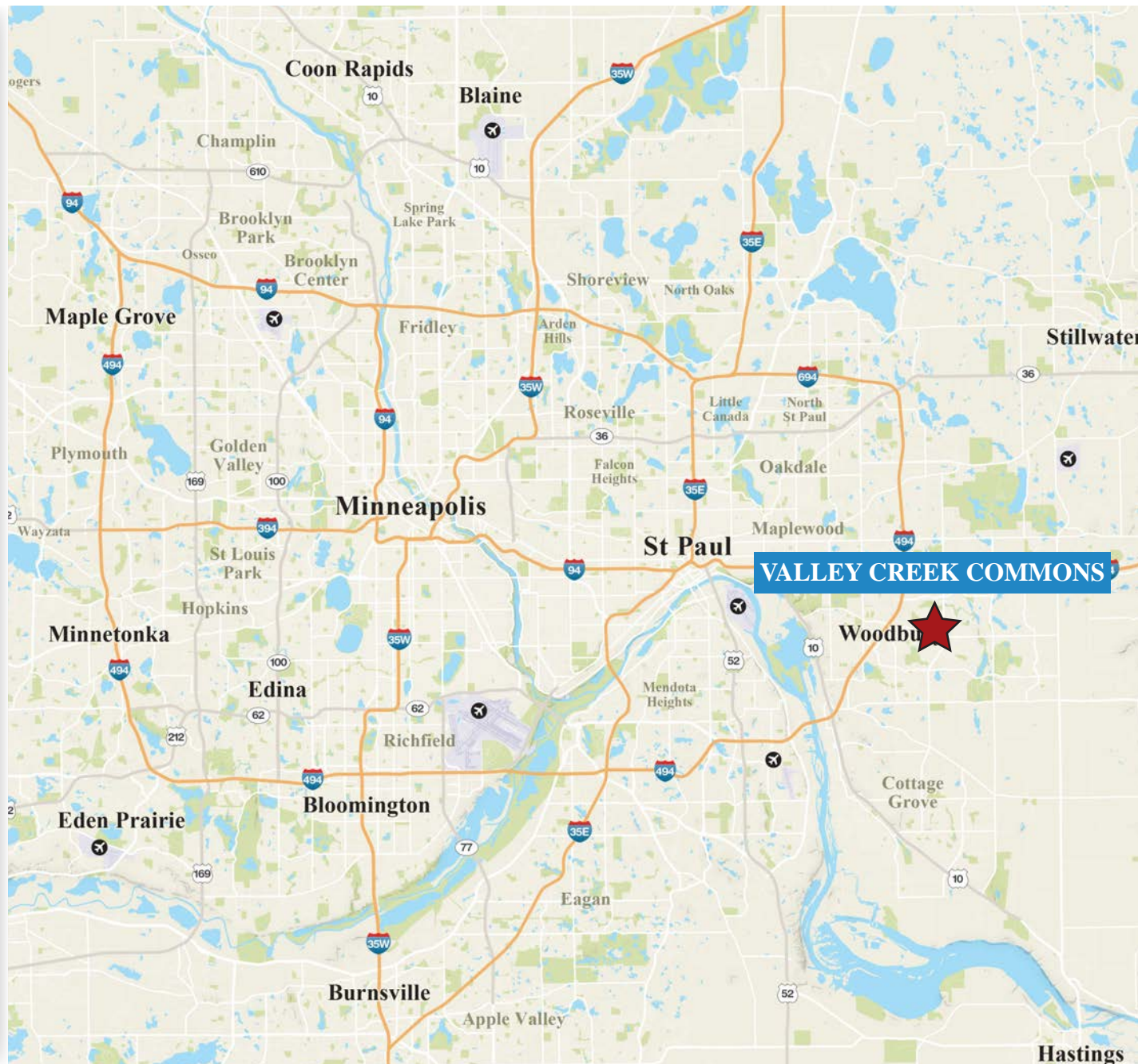

1625 Energy Park Drive, Suite 100, St. Paul, MN 55108 | Main (651) 292-9844 | Fax (651) 292-0072 | wellingtonmgt.com